

关于我们

自1974年以来意大利SinterSud公司通过现代技术和生产革新工艺制造优质硬质合金产品。

三十年的不断研究使SinterSud公司制造出品种繁多的硬质合金产品（特别是硬质合金圆棒、硬质合金长条和旋转镗合金）、标准产品和根据顾客的特殊要求而特别制造的产品。

SinterSud公司通过最严格的国际标准来检查和控制产品质量和生产过程的效率。SinterSud公司获得ISO 9001 - 2008 认证 (Vision 2008) 和 ISO14001-2004认证绝不是偶然的。

自2003年以来SinterSud公司所有的生产活动都是在意大利Sant'Agata Dè Goti (BN)的现代厂房里进行的。此厂房在技术、效率和环保方面具备最先进的机械设备，其中包括PVA和ALD的热等静压烧结炉和Dorst公司的自动化挤压机。

雄厚的生产实力和充足的库存使SinterSud公司可以在短期内满足顾客的各种不同需求。

SinterSud公司的所有员工都非常清楚满足顾客要求的重要性，认为顾客才是公司唯一真正的财富。技术、质量、专业性和可靠性是我们与顾客之间关系的关键因素。

如今SinterSud公司在硬质合金行业中是全球范围内的龙头企业之一。一如既往的工作热情激励着我们与顾客共同进步的愿望，并推动着我们在硬质合金领域中不断地迎接技术方面的新挑战。SinterSud公司欢迎您，我们将竭诚为您服务！



特性

硬质合金牌号 – 规格

| 牌号 | 碳化钨含量 % | 钴含量 % | 晶粒度 micron | 密度 g/cm ³ | 洛氏硬度 HRA | 维氏硬度 HV30 | 抗弯硬度 N/mm ² |
|-------------|------------|----------|---------------|-------------------------|-------------|--------------|---------------------------|
| MK12 | 88 | 12 | 超细的 | 14,33 | 92,5 | 1730 | 4500 |

适合于从40到55洛氏C标度硬度钢的粗加工和精加工。适合于用微铣刀对钢的精加工。

| | | | | | | | |
|-------------|------|-----|-----|-------|------|------|------|
| GF70 | 91,5 | 8,5 | 超细的 | 14,50 | 93,6 | 1950 | 4700 |
|-------------|------|-----|-----|-------|------|------|------|

适合于从55到65洛氏C标度硬度钢的高速精加工。适合于铸铁、有色金属、轻合金、复合金属、层压纸、木材和塑料的高速铣加工和高速钻孔加工。

| | | | | | | | |
|-------------|----|----|------|-------|------|------|------|
| K10F | 90 | 10 | 亚微细粒 | 14,48 | 92,1 | 1620 | 4150 |
|-------------|----|----|------|-------|------|------|------|

适合于钢加工，包括不淬硬钢，特别适合小于40洛氏C标度硬度的钢。适合于铝合金和有色金属材料的加工。可用于不锈钢、钛合金和镍基合金的加工。

| | | | | | | | |
|-------------|----|----|------|-------|------|------|------|
| K12F | 88 | 12 | 亚微细粒 | 14,22 | 91,1 | 1480 | 3740 |
|-------------|----|----|------|-------|------|------|------|

适合于不锈钢、镍基合金（超级耐热合金）和钛合金的加工。适合于软钢或韧性钢的波纹面或不均匀面的粗钻孔加工。不适合于硬化钢的加工。

| | | | | | | | |
|------------|----|-----|-----|-------|------|------|------|
| K30 | 91 | 9,0 | 中级的 | 14,63 | 91,0 | 1520 | 2900 |
|------------|----|-----|-----|-------|------|------|------|

适合于要求低磨损性而非常坚韧性的应用。适合于木材加工和断续切削加工。



INDEX

硬质合金产品目录

| | |
|---|----|
| Solid rods lenght 320mm quality K10 F.....pag . 1 | |
| 实心硬质合金圆棒 - 320mm 长 K10F..... | 1 |
| Solid rods lenght 320mm quality MK12.....pag . 6 | |
| 实心硬质合金圆棒 - 320mm 长 MK12..... | 6 |
| Solid rods with chamfer quality K10F.....pag. 11 | |
| 带凹槽的实心硬质合金圆棒 K10F..... | 11 |
| Solid rods lenght 330mm quality GF70.....pag. 12 | |
| 实心硬质合金圆棒 - 330mm 长 GF70..... | 12 |
| Oil feed rods with 1 axial coolant duct length 320mm quality K10F.....pag. 13 | |
| 单直孔硬质合金棒材- 320mm 长 K10F..... | 13 |
| Oil feed rods with 1 axial coolant duct length 320mm quality Mk12.....pag. 14 | |
| 单直孔硬质合金棒材 - 320mm 长 MK12..... | 14 |
| Oil feed rods with 1 axial coolant duct length 330mm quality GF70.....pag. 15 | |
| 单直孔硬质合金棒材 - 330mm 长 GF70..... | 15 |
| Oil feed rods with 2 parallel coolant duct length 320mm quality K10F..... pag. 16 | |
| 双直孔硬质合金棒材- 320mm 长 K10F..... | 16 |
| Oil feed rods with 2 parallel coolant duct length 320mm quality MK12.....pag. 17 | |
| 双直孔硬质合金棒材 - 320mm 长 MK12..... | 17 |

| | |
|---|---------|
| Oil feed rods with 2 parallel coolant duct length 330mm quality GF70..... | pag. 18 |
| 双直孔硬质合金棒材- 330mm 长 GF70..... | 18 |
| Solid rods with two helical holes 30° quality K10F..... | pag. 19 |
| 双螺旋孔硬质合金棒材 30°- 330mm 长 K10F..... | 19 |
| Solid rods with two helical holes 40° quality K10F..... | pag. 20 |
| 双螺旋孔硬质合金棒材 40°- 330mm 长 K10F..... | 20 |
| Reamers blanks quality K10F..... | pag. 21 |
| 铰刀坯 K10F..... | 21 |
| Square and rectangular blanks length 335 mmK10F- K30..... | pag. 22 |
| 不精磨方形和矩形硬质合金长条 - 335mm 长 K10F - K30..... | 22 |
| Center drills blanks quality K10F..... | pag. 23 |
| 中心钻 - K10F..... | 23 |
| Helical cutting edges blanks quality K10F..... | pag. 24 |
| 螺旋边坯 -K10F..... | 24 |
| Burr blanks quality K10f – K30..... | pag. 25 |
| 旋转锉合金 - K10F - K30..... | 25 |

实心硬质合金圆棒

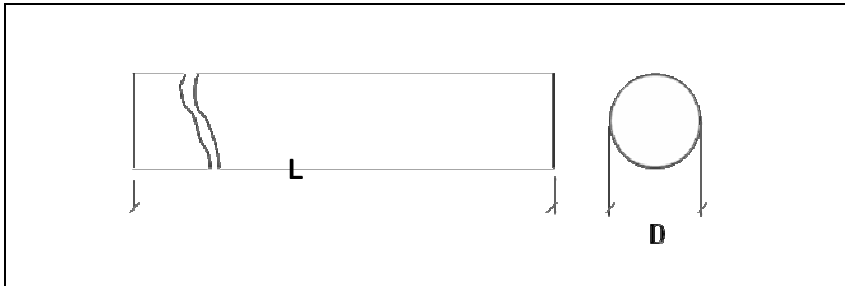

| 牌号 | | K10F | | | |
|------|-----|-----------------|--|------------------|--|
| 直径 | 长度 | 不精磨 | | 精磨 _{h6} | |
| mm | mm | | | | |
| 2,00 | 80 | GDK10FCG0200080 | | RDK10FCR0200080 | |
| 2,00 | 100 | GDK10FCG0200100 | | RDK10FCR0200100 | |
| 2,00 | 320 | GSK10FCG0200320 | | RSK10FCR0200320 | |
| 2,50 | 100 | GDK10FCG0250100 | | RDK10FCR0250100 | |
| 2,50 | 320 | GSK10FCG0250320 | | RSK10FCR0250320 | |
| 3,00 | 38 | GDK10FCG0300038 | | RDK10FCR0300038 | |
| 3,00 | 40 | GDK10FCG0300040 | | RDK10FCR0300040 | |
| 3,00 | 50 | GDK10FCG0300050 | | RDK10FCR0300050 | |
| 3,00 | 61 | GDK10FCG0300061 | | RDK10FCR0300061 | |
| 3,00 | 70 | GDK10FCG0300070 | | RDK10FCR0300070 | |
| 3,00 | 75 | GDK10FCG0300075 | | RDK10FCR0300075 | |
| 3,00 | 100 | GDK10FCG0300100 | | RDK10FCR0300100 | |
| 3,00 | 320 | GSK10FCG0300320 | | RSK10FCR0300320 | |
| 3,17 | 320 | 1/8 英寸 | | RSK10FCR0317320 | |
| 3,50 | 70 | GDK10FCG0350070 | | RDK10FCR0350070 | |
| 3,50 | 75 | GDK10FCG0350075 | | RDK10FCR0350075 | |
| 3,50 | 100 | GDK10FCG0350100 | | RDK10FCR0350100 | |
| 3,50 | 320 | GSK10FCG0350320 | | RSK10FCR0350320 | |
| 4,00 | 40 | GDK10FCG0400040 | | RDK10FCR0400040 | |
| 4,00 | 50 | GDK10FCG0400050 | | RDK10FCR0400050 | |
| 4,00 | 55 | GDK10FCG0400055 | | RDK10FCR0400055 | |
| 4,00 | 58 | GDK10FCG0400058 | | RDK10FCR0400058 | |
| 4,00 | 75 | GDK10FCG0400075 | | RDK10FCR0400075 | |
| 4,00 | 80 | GDK10FCG0400080 | | RDK10FCR0400080 | |
| 4,00 | 92 | GDK10FCG0400092 | | RDK10FCR0400092 | |

| | | | | | |
|------|-----|-----------------|--|-----------------|--|
| 4,00 | 100 | GDK10FCG0400100 | | RDK10FCR0400100 | |
| 4,00 | 320 | GSK10FCG0400320 | | RSK10FCR0400320 | |
| 4,50 | 58 | GDK10FCG0450058 | | RDK10FCR0450058 | |
| 4,50 | 80 | GDK10FCG0450080 | | RDK10FCR0450080 | |
| 4,50 | 86 | GDK10FCG0450086 | | RDK10FCR0450086 | |
| 4,50 | 100 | GDK10FCG0450100 | | RDK10FCR0450100 | |
| 4,50 | 320 | GSK10FCG0450320 | | RSK10FCR0450320 | |
| 4,76 | 320 | 3/16 英寸 | | RSK10FCR0476320 | |
| 5,00 | 50 | GDK10FCG0500050 | | RDK10FCR0500050 | |
| 5,00 | 62 | GDK10FCG0500062 | | RDK10FCR0500062 | |
| 5,00 | 66 | GDK10FCG0500066 | | RDK10FCR0500066 | |
| 5,00 | 75 | GDK10FCG0500075 | | RDK10FCR0500075 | |
| 5,00 | 86 | GDK10FCG0500086 | | RDK10FCR0500086 | |
| 5,00 | 93 | GDK10FCG0500093 | | RDK10FCR0500093 | |
| 5,00 | 100 | GDK10FCG0500100 | | RDK10FCR0500100 | |
| 5,00 | 320 | GSK10FCG0500320 | | RSK10FCR0500320 | |
| 5,50 | 93 | GDK10FCG0550093 | | RDK10FCR0550093 | |
| 5,50 | 100 | GDK10FCG0550100 | | RDK10FCR0550100 | |
| 5,50 | 320 | GSK10FCG0550320 | | RSK10FCR0550320 | |
| 6,00 | 50 | GDK10FCG0600050 | | RDK10FCR0600050 | |
| 6,00 | 54 | GDK10FCG0600054 | | RDK10FCR0600054 | |
| 6,00 | 57 | GDK10FCG0600057 | | RDK10FCR0600057 | |
| 6,00 | 60 | GDK10FCG0600060 | | RDK10FCR0600060 | |
| 6,00 | 66 | GDK10FCG0600066 | | RDK10FCR0600066 | |
| 6,00 | 70 | GDK10FCG0600070 | | RDK10FCR0600070 | |
| 6,00 | 75 | GDK10FCG0600075 | | RDK10FCR0600075 | |
| 6,00 | 80 | GDK10FCG0600080 | | RDK10FCR0600080 | |
| 6,00 | 93 | GDK10FCG0600093 | | RDK10FCR0600093 | |
| 6,00 | 100 | GDK10FCG0600100 | | RDK10FCR0600100 | |
| 6,00 | 150 | GDK10FCG0600150 | | RDK10FCR0600150 | |
| 6,00 | 320 | GSK10FCG0600320 | | RSK10FCR0600320 | |
| 6,35 | 320 | 1/4 英寸 | | RSK10FCR0635320 | |
| 6,50 | 70 | GDK10FCG0650070 | | RDK10FCR0650070 | |
| 6,50 | 100 | GDK10FCG0650100 | | RDK10FCR0650100 | |
| 6,50 | 109 | GDK10FCG0650109 | | RDK10FCR0650109 | |
| 6,50 | 320 | GSK10FCG0650320 | | RSK10FCR0650320 | |
| 7,00 | 60 | GDK10FCG0700060 | | RDK10FCR0700060 | |
| 7,00 | 80 | GDK10FCG0700080 | | RDK10FCR0700080 | |
| 7,00 | 100 | GDK10FCG0700100 | | RDK10FCR0700100 | |
| 7,00 | 320 | GSK10FCG0700320 | | RSK10FCR0700320 | |
| 7,50 | 100 | GDK10FCG0750100 | | RDK10FCR0750100 | |
| 7,50 | 109 | GDK10FCG0750109 | | RDK10FCR0750109 | |
| 7,50 | 117 | GDK10FCG0750117 | | RDK10FCR0750117 | |
| 7,50 | 320 | GSK10FCG0750320 | | RSK10FCR0750320 | |
| 7,93 | 320 | 5/16 英寸 | | RSK10FCR0793320 | |
| 8,00 | 60 | GDK10FCG0800060 | | RDK10FCR0800060 | |
| 8,00 | 63 | GDK10FCG0800063 | | RDK10FCR0800063 | |
| 8,00 | 75 | GDK10FCG0800075 | | RDK10FCR0800075 | |
| 8,00 | 80 | GDK10FCG0800080 | | RDK10FCR0800080 | |
| 8,00 | 100 | GDK10FCG0800100 | | RDK10FCR0800100 | |
| 8,00 | 117 | GDK10FCG0800117 | | RDK10FCR0800117 | |
| 8,00 | 150 | GDK10FCG0800150 | | RDK10FCR0800150 | |
| 8,00 | 320 | GSK10FCG0800320 | | RSK10FCR0800320 | |
| 8,50 | 79 | GDK10FCG0850079 | | RDK10FCR0850079 | |
| 8,50 | 100 | GDK10FCG0850100 | | RDK10FCR0850100 | |

| | | | | | |
|-------|-----|-----------------|--|-----------------|--|
| 8,50 | 125 | GDK10FCG0850125 | | RDK10FCR0850125 | |
| 8,50 | 320 | GSK10FCG0850320 | | RSK10FCR0850320 | |
| 9,00 | 66 | GDK10FCG0900066 | | RDK10FCR0900066 | |
| 9,00 | 84 | GDK10FCG0900084 | | RDK10FCR0900084 | |
| 9,00 | 100 | GDK10FCG0900100 | | RDK10FCR0900100 | |
| 9,00 | 125 | GDK10FCG0900125 | | RDK10FCR0900125 | |
| 9,00 | 320 | GSK10FCG0900320 | | RSK10FCR0900320 | |
| 9,50 | 100 | GDK10FCG0950100 | | RDK10FCR0950100 | |
| 9,50 | 125 | GDK10FCG0950125 | | RDK10FCR0950125 | |
| 9,50 | 133 | GDK10FCG0950133 | | RDK10FCR0950133 | |
| 9,50 | 320 | GSK10FCG0950320 | | RSK10FCR0950320 | |
| 9,52 | 320 | 3/8 英寸 | | RSK10FCR0952320 | |
| 10,00 | 66 | GDK10FCG1000066 | | RDK10FCR1000066 | |
| 10,00 | 70 | GDK10FCG1000070 | | RDK10FCR1000070 | |
| 10,00 | 72 | GDK10FCG1000072 | | RDK10FCR1000072 | |
| 10,00 | 75 | GDK10FCG1000075 | | RDK10FCR1000075 | |
| 10,00 | 89 | GDK10FCG1000089 | | RDK10FCR1000089 | |
| 10,00 | 100 | GDK10FCG1000100 | | RDK10FCR1000100 | |
| 10,00 | 110 | GDK10FCG1000110 | | RDK10FCR1000110 | |
| 10,00 | 133 | GDK10FCG1000133 | | RDK10FCR1000133 | |
| 10,00 | 150 | GDK10FCG1000150 | | RDK10FCR1000150 | |
| 10,00 | 320 | GSK10FCG1000320 | | RSK10FCR1000320 | |
| 10,50 | 89 | GDK10FCG1050089 | | RDK10FCR1050089 | |
| 10,50 | 100 | GDK10FCG1050100 | | RDK10FCR1050100 | |
| 10,50 | 133 | GDK10FCG1050133 | | RDK10FCR1050133 | |
| 10,50 | 142 | GDK10FCG1050142 | | RDK10FCR1050142 | |
| 10,50 | 320 | GSK10FCG1050320 | | RSK10FCR1050320 | |
| 11,00 | 100 | GDK10FCG1100100 | | RDK10FCR1100100 | |
| 11,00 | 142 | GDK10FCG1100142 | | RDK10FCR1100142 | |
| 11,00 | 320 | GSK10FCG1100320 | | RSK10FCR1100320 | |
| 11,11 | 320 | 7/16 英寸 | | RSK10FCR1111320 | |
| 11,50 | 100 | GDK10FCG1150100 | | RDK10FCR1150100 | |
| 11,50 | 320 | GSK10FCG1150320 | | RSK10FCR1150320 | |
| 12,00 | 73 | GDK10FCG1200073 | | RDK10FCR1200073 | |
| 12,00 | 75 | GDK10FCG1200075 | | RDK10FCR1200075 | |
| 12,00 | 83 | GDK10FCG1200083 | | RDK10FCR1200083 | |
| 12,00 | 100 | GDK10FCG1200100 | | RDK10FCR1200100 | |
| 12,00 | 102 | GDK10FCG1200102 | | RDK10FCR1200102 | |
| 12,00 | 110 | GDK10FCG1200110 | | RDK10FCR1200110 | |
| 12,00 | 150 | GDK10FCG1200150 | | RDK10FCR1200150 | |
| 12,00 | 320 | GSK10FCG1200320 | | RSK10FCR1200320 | |
| 12,50 | 100 | GDK10FCG1250100 | | RDK10FCR1250100 | |
| 12,50 | 151 | GDK10FCG1250151 | | RDK10FCR1250151 | |
| 12,50 | 320 | GSK10FCG1250320 | | RSK10FCR1250320 | |
| 12,70 | 320 | 1/2 英寸 | | RSK10FCR1270320 | |
| 13,00 | 100 | GDK10FCG1300100 | | RDK10FCR1300100 | |
| 13,00 | 151 | GDK10FCG1300151 | | RDK10FCR1300151 | |
| 13,00 | 320 | GSK10FCG1300320 | | RSK10FCR1300320 | |
| 13,50 | 100 | GDK10FCG1350100 | | RDK10FCR1350100 | |
| 13,50 | 320 | GSK10FCG1350320 | | RSK10FCR1350320 | |
| 14,00 | 75 | GDK10FCG1400075 | | RDK10FCR1400075 | |
| 14,00 | 82 | GDK10FCG1400082 | | RDK10FCR1400082 | |
| 14,00 | 85 | GDK10FCG1400085 | | RDK10FCR1400085 | |
| 14,00 | 92 | GDK10FCG1400092 | | RDK10FCR1400092 | |
| 14,00 | 100 | GDK10FCG1400100 | | RDK10FCR1400100 | |

| | | | | | |
|-------|-----|-----------------|--|-----------------|--|
| 14,00 | 110 | GDK10FCG1400110 | | RDK10FCR1400110 | |
| 14,00 | 120 | GDK10FCG1400120 | | RDK10FCR1400120 | |
| 14,00 | 150 | GDK10FCG1400150 | | RDK10FCR1400150 | |
| 14,00 | 320 | GSK10FCG1400320 | | RSK10FCR1400320 | |
| 14,28 | 320 | 9/16 英寸 | | RSK10FCR1428320 | |
| 14,50 | 100 | GDK10FCG1450100 | | RDK10FCR1450100 | |
| 14,50 | 320 | GSK10FCG1450320 | | RSK10FCR1450320 | |
| 15,00 | 92 | GDK10FCG1500092 | | RDK10FCR1500092 | |
| 15,00 | 100 | GDK10FCG1500100 | | RDK10FCR1500100 | |
| 15,00 | 130 | GDK10FCG1500130 | | RDK10FCR1500130 | |
| 15,00 | 320 | GSK10FCG1500320 | | RSK10FCR1500320 | |
| 15,50 | 100 | GDK10FCG1550100 | | RDK10FCR1550100 | |
| 15,50 | 320 | GSK10FCG1550320 | | RSK10FCR1550320 | |
| 15,87 | 320 | 5/8 英寸 | | RSK10FCR1587320 | |
| 16,00 | 82 | GDK10FCG1600082 | | RDK10FCR1600082 | |
| 16,00 | 92 | GDK10FCG1600092 | | RDK10FCR1600092 | |
| 16,00 | 100 | GDK10FCG1600100 | | RDK10FCR1600100 | |
| 16,00 | 110 | GDK10FCG1600110 | | RDK10FCR1600110 | |
| 16,00 | 130 | GDK10FCG1600130 | | RDK10FCR1600130 | |
| 16,00 | 140 | GDK10FCG1600140 | | RDK10FCR1600140 | |
| 16,00 | 150 | GDK10FCG1600150 | | RDK10FCR1600150 | |
| 16,00 | 320 | GSK10FCG1600320 | | RSK10FCR1600320 | |
| 16,50 | 100 | GDK10FCG1650100 | | RDK10FCR1650100 | |
| 16,50 | 320 | GSK10FCG1650320 | | RSK10FCR1650320 | |
| 17,00 | 92 | GDK10FCG1700092 | | RDK10FCR1700092 | |
| 17,00 | 100 | GDK10FCG1700100 | | RDK10FCR1700100 | |
| 17,00 | 320 | GSK10FCG1700320 | | RSK10FCR1700320 | |
| 17,50 | 100 | GDK10FCG1750100 | | RDK10FCR1750100 | |
| 17,50 | 320 | GSK10FCG1750320 | | RSK10FCR1750320 | |
| 18,00 | 84 | GDK10FCG1800084 | | RDK10FCR1800084 | |
| 18,00 | 92 | GDK10FCG1800092 | | RDK10FCR1800092 | |
| 18,00 | 100 | GDK10FCG1800100 | | RDK10FCR1800100 | |
| 18,00 | 110 | GDK10FCG1800110 | | RDK10FCR1800110 | |
| 18,00 | 130 | GDK10FCG1800130 | | RDK10FCR1800130 | |
| 18,00 | 150 | GDK10FCG1800150 | | RDK10FCR1800150 | |
| 18,00 | 320 | GSK10FCG1800320 | | RSK10FCR1800320 | |
| 18,50 | 100 | GDK10FCG1850100 | | RDK10FCR1850100 | |
| 18,50 | 320 | GSK10FCG1850320 | | RSK10FCR1850320 | |
| 19,00 | 100 | GDK10FCG1900100 | | RDK10FCR1900100 | |
| 19,00 | 160 | GDK10FCG1900160 | | RDK10FCR1900160 | |
| 19,00 | 320 | GSK10FCG1900320 | | RSK10FCR1900320 | |
| 19,05 | 320 | 3/4 英寸 | | RSK10FCR1905320 | |
| 19,50 | 100 | GDK10FCG1950100 | | RDK10FCR1950100 | |
| 19,50 | 320 | GSK10FCG1950320 | | RSK10FCR1950320 | |
| 20,00 | 92 | GDK10FCG2000092 | | RDK10FCR2000092 | |
| 20,00 | 100 | GDK10FCG2000100 | | RDK10FCR2000100 | |
| 20,00 | 104 | GDK10FCG2000104 | | RDK10FCR2000104 | |
| 20,00 | 110 | GDK10FCG2000110 | | RDK10FCR2000110 | |
| 20,00 | 120 | GDK10FCG2000120 | | RDK10FCR2000120 | |
| 20,00 | 130 | GDK10FCG2000130 | | RDK10FCR2000130 | |
| 20,00 | 150 | GDK10FCG2000150 | | RDK10FCR2000150 | |
| 20,00 | 165 | GDK10FCG2000165 | | RDK10FCR2000165 | |
| 20,00 | 320 | GSK10FCG2000320 | | RSK10FCR2000320 | |
| 20,50 | 320 | GSK10FCG2000320 | | RSK10FCR2000320 | |
| 21,00 | 100 | GDK10FCG2100100 | | RDK10FCR2100100 | |

| | | | | | |
|-------|-----|-----------------|--|-----------------|--|
| 21,00 | 320 | GSK10FCG2100320 | | RSK10FCR2100320 | |
| 21,50 | 320 | GSK10FCG2150320 | | RSK10FCR2150320 | |
| 22,00 | 100 | GDK10FCG2200100 | | RDK10FCR2200100 | |
| 22,00 | 110 | GDK10FCG2200110 | | RDK10FCR2200110 | |
| 22,00 | 130 | GDK10FCG2200130 | | RDK10FCR2200130 | |
| 22,00 | 150 | GDK10FCG2200150 | | RDK10FCR2200150 | |
| 22,00 | 320 | GSK10FCG2200320 | | RSK10FCR2200320 | |
| 22,22 | 320 | 7/8 英寸 | | RSK10FCR2222320 | |
| 22,50 | 320 | GSK10FCG2250320 | | RSK10FCR2250320 | |
| 23,00 | 100 | GDK10FCG2300100 | | RDK10FCR2300100 | |
| 23,00 | 320 | GSK10FCG2300320 | | RSK10FCR2300320 | |
| 23,50 | 320 | GSK10FCG2350320 | | RSK10FCR2350320 | |
| 24,00 | 100 | GDK10FCG2400100 | | RDK10FCR2400100 | |
| 24,00 | 110 | GDK10FCG2400110 | | RDK10FCR2400110 | |
| 24,00 | 130 | GDK10FCG2400130 | | RDK10FCR2400130 | |
| 24,00 | 320 | GSK10FCG2400320 | | RSK10FCR2400320 | |
| 24,50 | 320 | GSK10FCG2450320 | | RSK10FCR2450320 | |
| 25,00 | 100 | GDK10FCG2500100 | | RDK10FCR2500100 | |
| 25,00 | 110 | GDK10FCG2500110 | | RDK10FCR2500110 | |
| 25,00 | 130 | GDK10FCG2500130 | | RDK10FCR2500130 | |
| 25,00 | 150 | GDK10FCG2500150 | | RDK10FCR2500150 | |
| 25,00 | 320 | GSK10FCG2500320 | | RSK10FCR2500320 | |
| 25,40 | 320 | 1 英寸 | | RSK10FCR2540320 | |
| 26,00 | 100 | GDK10FCG2600100 | | RDK10FCR2600100 | |
| 26,00 | 110 | GDK10FCG2600110 | | RDK10FCR2600110 | |
| 26,00 | 130 | GDK10FCG2600130 | | RDK10FCR2600130 | |
| 26,00 | 150 | GDK10FCG2600150 | | RDK10FCR2600150 | |
| 26,00 | 320 | GSK10FCG2600320 | | RSK10FCR2600320 | |
| 27,00 | 320 | GSK10FCG2700320 | | RSK10FCR2700320 | |
| 28,00 | 130 | GDK10FCG2800130 | | RDK10FCR2800130 | |
| 28,00 | 320 | GSK10FCG2800320 | | RSK10FCR2800320 | |
| 29,00 | 320 | GSK10FCG2900320 | | RSK10FCR2900320 | |
| 30,00 | 130 | GDK10FCG3000130 | | RDK10FCR3000130 | |
| 30,00 | 150 | GDK10FCG3000150 | | RDK10FCR3000150 | |
| 30,00 | 320 | GSK10FCG3000320 | | RSK10FCR3000320 | |
| 31,00 | 320 | GSK10FCG3100320 | | RSK10FCR3100320 | |
| 32,00 | 130 | GDK10FCG3200130 | | RDK10FCR3200130 | |
| 32,00 | 150 | GDK10FCG3200150 | | RDK10FCR3200150 | |
| 32,00 | 320 | GSK10FCG3200320 | | RSK10FCR3200320 | |
| 33,00 | 320 | GSK10FCG3300320 | | RSK10FCR3300320 | |
| 34,00 | 320 | GSK10FCG3300320 | | RSK10FCR3300320 | |
| 35,00 | 320 | GSK10FCG3500320 | | RSK10FCR3500320 | |
| 36,00 | 320 | GSK10FCG3600320 | | RSK10FCR3600320 | |
| 37,00 | 320 | GSK10FCG3700320 | | RSK10FCR3700320 | |
| 38,00 | 320 | GSK10FCG3800320 | | RSK10FCR3800320 | |
| 39,00 | 320 | GSK10FCG3900320 | | RSK10FCR3900320 | |
| 40,00 | 320 | GSK10FCG4000320 | | RSK10FCR4000320 | |
| 45,00 | 320 | GSK10FCG4500320 | | RSK10FCR4500320 | |

实心硬质合金圆棒

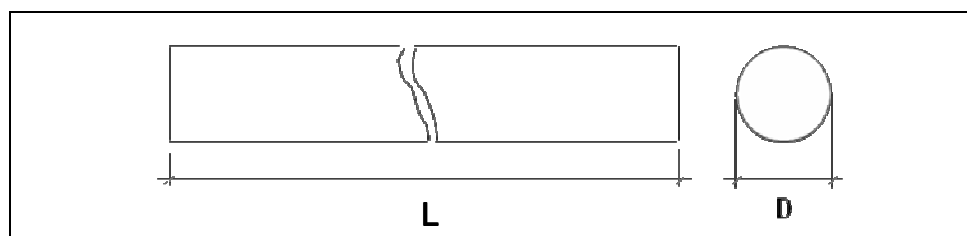

| 牌号 | | MK12 | | | |
|----------|----------|-----------------|--|------------------|--|
| 直径 mm | 长度 mm | 不精磨 | | 精磨 _{h6} | |
| 3,00 | 38 | GDMK12CG0300038 | | RDMK12CR0300038 | |
| 3,00 | 40 | GDMK12CG0300040 | | RDMK12CR0300040 | |
| 3,00 | 50 | GDMK12CG0300050 | | RDMK12CR0300050 | |
| 3,00 | 61 | GDMK12CG0300061 | | RDMK12CR0300061 | |
| 3,00 | 70 | GDMK12CG0300070 | | RDMK12CR0300070 | |
| 3,00 | 75 | GDMK12CG0300075 | | RDMK12CR0300075 | |
| 3,00 | 100 | GDMK12CG0300100 | | RDMK12CR0300100 | |
| 3,00 | 320 | GSMK12CG0300320 | | RSMK12CR0300320 | |
| 3,17 | 320 | GSMK12CG0317320 | | RSMK12CR0317320 | |
| 3,50 | 70 | GDMK12CG0350070 | | RDMK12CR0350070 | |
| 3,50 | 75 | GDMK12CG0350075 | | RDMK12CR0350075 | |
| 3,50 | 100 | GDMK12CG0350100 | | RDMK12CR0350100 | |
| 3,50 | 320 | GSMK12CG0350320 | | RSMK12CR0350320 | |
| 4,00 | 40 | GDMK12CG0400040 | | RDMK12CR0400040 | |
| 4,00 | 50 | GDMK12CG0400050 | | RDMK12CR0400050 | |
| 4,00 | 55 | GDMK12CG0400055 | | RDMK12CR0400055 | |
| 4,00 | 58 | GDMK12CG0400058 | | RDMK12CR0400058 | |
| 4,00 | 75 | GDMK12CG0400075 | | RDMK12CR0400075 | |
| 4,00 | 80 | GDMK12CG0400080 | | RDMK12CR0400080 | |
| 4,00 | 92 | GDMK12CG0400092 | | RDMK12CR0400092 | |
| 4,00 | 100 | GDMK12CG0400100 | | RDMK12CR0400100 | |
| 4,00 | 320 | GSMK12CG0400320 | | RSMK12CR0400320 | |
| 4,50 | 58 | GDMK12CG0450058 | | RDMK12CR0450058 | |
| 4,50 | 80 | GDMK12CG0450080 | | RDMK12CR0450080 | |
| 4,50 | 86 | GDMK12CG0450086 | | RDMK12CR0450086 | |
| 4,50 | 100 | GDMK12CG0450100 | | RDMK12CR0450100 | |
| 4,50 | 320 | GSMK12CG0450320 | | RSMK12CR0450320 | |
| 4,76 | 320 | GSMK12CG0476320 | | RSMK12CR0476320 | |

| | | | | | |
|------|-----|-----------------|--|-----------------|--|
| 5,00 | 50 | GDMK12CG0500050 | | RDMK12CR0500050 | |
| 5,00 | 62 | GDMK12CG0500062 | | RDMK12CR0500062 | |
| 5,00 | 66 | GDMK12CG0500066 | | RDMK12CR0500066 | |
| 5,00 | 75 | GDMK12CG0500075 | | RDMK12CR0500075 | |
| 5,00 | 86 | GDMK12CG0500086 | | RDMK12CR0500086 | |
| 5,00 | 93 | GDMK12CG0500093 | | RDMK12CR0500093 | |
| 5,00 | 100 | GDMK12CG0500100 | | RDMK12CR0500100 | |
| 5,00 | 320 | GSMK12CG0500320 | | RSMK12CR0500320 | |
| 5,50 | 93 | GDMK12CG0550093 | | RDMK12CR0550093 | |
| 5,50 | 100 | GDMK12CG0550100 | | RDMK12CR0550100 | |
| 5,50 | 320 | GSMK12CG0550320 | | RSMK12CR0550320 | |
| 6,00 | 50 | GDMK12CG0600050 | | RDMK12CR0600050 | |
| 6,00 | 54 | GDMK12CG0600054 | | RDMK12CR0600054 | |
| 6,00 | 57 | GDMK12CG0600057 | | RDMK12CR0600057 | |
| 6,00 | 60 | GDMK12CG0600060 | | RDMK12CR0600060 | |
| 6,00 | 66 | GDMK12CG0600066 | | RDMK12CR0600066 | |
| 6,00 | 70 | GDMK12CG0600070 | | RDMK12CR0600070 | |
| 6,00 | 75 | GDMK12CG0600075 | | RDMK12CR0600075 | |
| 6,00 | 80 | GDMK12CG0600080 | | RDMK12CR0600080 | |
| 6,00 | 93 | GDMK12CG0600093 | | RDMK12CR0600093 | |
| 6,00 | 100 | GDMK12CG0600100 | | RDMK12CR0600100 | |
| 6,00 | 150 | GDMK12CG0600150 | | RDMK12CR0600150 | |
| 6,00 | 320 | GSMK12CG0600320 | | RSMK12CR0600320 | |
| 6,35 | 320 | GSMK12CG0635320 | | RSMK12CR0635320 | |
| 6,50 | 70 | GDMK12CG0650070 | | RDMK12CR0650070 | |
| 6,50 | 100 | GDMK12CG0650100 | | RDMK12CR0650100 | |
| 6,50 | 109 | GDMK12CG0650109 | | RDMK12CR0650109 | |
| 6,50 | 320 | GSMK12CG0650320 | | RSMK12CR0650320 | |
| 7,00 | 60 | GDMK12CG0700060 | | RDMK12CR0700060 | |
| 7,00 | 80 | GDMK12CG0700080 | | RDMK12CR0700080 | |
| 7,00 | 100 | GDMK12CG0700100 | | RDMK12CR0700100 | |
| 7,00 | 320 | GSMK12CG0700320 | | RSMK12CR0700320 | |
| 7,50 | 100 | GDMK12CG0750100 | | RDMK12CR0750100 | |
| 7,50 | 109 | GDMK12CG0750109 | | RDMK12CR0750109 | |
| 7,50 | 117 | GDMK12CG0750117 | | RDMK12CR0750117 | |
| 7,50 | 320 | GSMK12CG0750320 | | RSMK12CR0750320 | |
| 8,00 | 60 | GDMK12CG0800060 | | RDMK12CR0800060 | |
| 8,00 | 63 | GDMK12CG0800063 | | RDMK12CR0800063 | |
| 8,00 | 75 | GDMK12CG0800075 | | RDMK12CR0800075 | |
| 8,00 | 80 | GDMK12CG0800080 | | RDMK12CR0800080 | |
| 8,00 | 100 | GDMK12CG0800100 | | RDMK12CR0800100 | |
| 8,00 | 117 | GDMK12CG0800117 | | RDMK12CR0800117 | |
| 8,00 | 150 | GDMK12CG0800150 | | RDMK12CR0800150 | |
| 8,00 | 320 | GSMK12CG0800320 | | RSMK12CR0800320 | |
| 8,50 | 79 | GDMK12CG0850079 | | RDMK12CR0850079 | |
| 8,50 | 100 | GDMK12CG0850100 | | RDMK12CR0850100 | |
| 8,50 | 125 | GDMK12CG0850125 | | RDMK12CR0850125 | |
| 8,50 | 320 | GSMK12CG0850320 | | RSMK12CR0850320 | |
| 9,00 | 66 | GDMK12CG0900066 | | RDMK12CR0900066 | |
| 9,00 | 84 | GDMK12CG0900084 | | RDMK12CR0900084 | |
| 9,00 | 100 | GDMK12CG0900100 | | RDMK12CR0900100 | |
| 9,00 | 125 | GDMK12CG0900125 | | RDMK12CR0900125 | |
| 9,00 | 320 | GSMK12CG0900320 | | RSMK12CR0900320 | |
| 9,50 | 100 | GDMK12CG0950100 | | RDMK12CR0950100 | |
| 9,50 | 125 | GDMK12CG0950125 | | RDMK12CR0950125 | |

| | | | | | |
|-------|-----|-----------------|--|-----------------|--|
| 9,50 | 133 | GDMK12CG0950133 | | RDMK12CR0950133 | |
| 9,50 | 320 | GSMK12CG0950320 | | RSMK12CR0950320 | |
| 9,52 | 320 | GSMK12CG0952320 | | RSMK12CR0952320 | |
| 10,00 | 66 | GDMK12CG1000066 | | RDMK12CR1000066 | |
| 10,00 | 70 | GDMK12CG1000070 | | RDMK12CR1000070 | |
| 10,00 | 72 | GDMK12CG1000072 | | RDMK12CR1000072 | |
| 10,00 | 75 | GDMK12CG1000075 | | RDMK12CR1000075 | |
| 10,00 | 89 | GDMK12CG1000089 | | RDMK12CR1000089 | |
| 10,00 | 100 | GDMK12CG1000100 | | RDMK12CR1000100 | |
| 10,00 | 110 | GDMK12CG1000110 | | RDMK12CR1000110 | |
| 10,00 | 133 | GDMK12CG1000133 | | RDMK12CR1000133 | |
| 10,00 | 150 | GDMK12CG1000150 | | RDMK12CR1000150 | |
| 10,00 | 320 | GSMK12CG1000320 | | RSMK12CR1000320 | |
| 10,50 | 89 | GDMK12CG1050089 | | RDMK12CR1050089 | |
| 10,50 | 100 | GDMK12CG1050100 | | RDMK12CR1050100 | |
| 10,50 | 133 | GDMK12CG1050133 | | RDMK12CR1050133 | |
| 10,50 | 142 | GDMK12CG1050142 | | RDMK12CR1050142 | |
| 10,50 | 320 | GSMK12CG1050320 | | RSMK12CR1050320 | |
| 11,00 | 100 | GDMK12CG1100100 | | RDMK12CR1100100 | |
| 11,00 | 320 | GSMK12CG1100320 | | RSMK12CR1100320 | |
| 11,00 | 142 | GDMK12CG1100142 | | RDMK12CR1100142 | |
| 11,50 | 100 | GDMK12CG1150100 | | RDMK12CR1150100 | |
| 11,50 | 320 | GSMK12CG1150320 | | RSMK12CR1150320 | |
| 12,00 | 73 | GDMK12CG1200073 | | RDMK12CR1200073 | |
| 12,00 | 75 | GDMK12CG1200075 | | RDMK12CR1200075 | |
| 12,00 | 83 | GDMK12CG1200083 | | RDMK12CR1200083 | |
| 12,00 | 100 | GDMK12CG1200100 | | RDMK12CR1200100 | |
| 12,00 | 102 | GDMK12CG1200102 | | RDMK12CR1200102 | |
| 12,00 | 110 | GDMK12CG1200110 | | RDMK12CR1200110 | |
| 12,00 | 150 | GDMK12CG1200150 | | RDMK12CR1200150 | |
| 12,00 | 320 | GSMK12CG1200320 | | RSMK12CR1200320 | |
| 12,50 | 100 | GDMK12CG1250100 | | RDMK12CR1250100 | |
| 12,50 | 151 | GDMK12CG1250151 | | RDMK12CR1250151 | |
| 12,50 | 320 | GSMK12CG1250320 | | RSMK12CR1250320 | |
| 12,70 | 320 | GSMK12CG1270320 | | RSMK12CR1270320 | |
| 13,00 | 100 | GDMK12CG1300100 | | RDMK12CR1300100 | |
| 13,00 | 151 | GDMK12CG1300151 | | RDMK12CR1300151 | |
| 13,00 | 320 | GSMK12CG1300320 | | RSMK12CR1300320 | |
| 13,50 | 100 | GDMK12CG1350100 | | RDMK12CR1350100 | |
| 13,50 | 320 | GSMK12CG1350320 | | RSMK12CR1350320 | |
| 14,00 | 75 | GDMK12CG1400075 | | RDMK12CR1400075 | |
| 14,00 | 82 | GDMK12CG1400082 | | RDMK12CR1400082 | |
| 14,00 | 85 | GDMK12CG1400085 | | RDMK12CR1400085 | |
| 14,00 | 92 | GDMK12CG1400092 | | RDMK12CR1400092 | |
| 14,00 | 100 | GDMK12CG1400100 | | RDMK12CR1400100 | |
| 14,00 | 110 | GDMK12CG1400110 | | RDMK12CR1400110 | |
| 14,00 | 120 | GDMK12CG1400120 | | RDMK12CR1400120 | |
| 14,00 | 150 | GDMK12CG1400150 | | RDMK12CR1400150 | |
| 14,00 | 320 | GSMK12CG1400320 | | RSMK12CR1400320 | |
| 14,50 | 100 | GDMK12CG1450100 | | RDMK12CR1450100 | |
| 14,50 | 320 | GSMK12CG1450320 | | RSMK12CR1450320 | |
| 15,00 | 92 | GDMK12CG1500092 | | RDMK12CR1500092 | |
| 15,00 | 100 | GDMK12CG1500100 | | RDMK12CR1500100 | |
| 15,00 | 130 | GDMK12CG1500130 | | RDMK12CR1500130 | |
| 15,00 | 320 | GSMK12CG1500320 | | RSMK12CR1500320 | |

| | | | | | |
|-------|-----|-----------------|--|-----------------|--|
| 15,50 | 100 | GDMK12CG1550100 | | RDMK12CR1550100 | |
| 15,50 | 320 | GSMK12CG1550320 | | RSMK12CR1550320 | |
| 15,87 | 320 | GSMK12CG1587320 | | RSMK12CR1587320 | |
| 16,00 | 82 | GDMK12CG1600082 | | RDMK12CR1600082 | |
| 16,00 | 92 | GDMK12CG1600092 | | RDMK12CR1600092 | |
| 16,00 | 100 | GDMK12CG1600100 | | RDMK12CR1600100 | |
| 16,00 | 110 | GDMK12CG1600110 | | RDMK12CR1600110 | |
| 16,00 | 130 | GDMK12CG1600130 | | RDMK12CR1600130 | |
| 16,00 | 140 | GDMK12CG1600140 | | RDMK12CR1600140 | |
| 16,00 | 150 | GDMK12CG1600150 | | RDMK12CR1600150 | |
| 16,00 | 320 | GSMK12CG1600320 | | RSMK12CR1600320 | |
| 16,50 | 100 | GDMK12CG1650100 | | RDMK12CR1650100 | |
| 16,50 | 320 | GSMK12CG1650320 | | RSMK12CR1650320 | |
| 17,00 | 92 | GDMK12CG1700092 | | RDMK12CR1700092 | |
| 17,00 | 100 | GDMK12CG1700100 | | RDMK12CR1700100 | |
| 17,00 | 320 | GSMK12CG1700320 | | RSMK12CR1700320 | |
| 17,50 | 100 | GDMK12CG1750100 | | RDMK12CR1750100 | |
| 17,50 | 320 | GSMK12CG1750320 | | RSMK12CR1750320 | |
| 18,00 | 84 | GDMK12CG1800084 | | RDMK12CR1800084 | |
| 18,00 | 92 | GDMK12CG1800092 | | RDMK12CR1800092 | |
| 18,00 | 100 | GDMK12CG1800100 | | RDMK12CR1800100 | |
| 18,00 | 110 | GDMK12CG1800110 | | RDMK12CR1800110 | |
| 18,00 | 130 | GDMK12CG1800130 | | RDMK12CR1800130 | |
| 18,00 | 150 | GDMK12CG1800150 | | RDMK12CR1800150 | |
| 18,00 | 320 | GSMK12CG1800320 | | RSMK12CR1800320 | |
| 18,50 | 100 | GDMK12CG1850100 | | RDMK12CR1850100 | |
| 18,50 | 320 | GSMK12CG1850320 | | RSMK12CR1850320 | |
| 19,00 | 100 | GDMK12CG1900100 | | RDMK12CR1900100 | |
| 19,00 | 160 | GDMK12CG1900160 | | RDMK12CR1900160 | |
| 19,00 | 320 | GSMK12CG1900320 | | RSMK12CR1900320 | |
| 19,05 | 320 | GSMK12CG1905320 | | RSMK12CR1905320 | |
| 19,50 | 100 | GDMK12CG1950100 | | RDMK12CR1950100 | |
| 19,50 | 320 | GSMK12CG1950320 | | RSMK12CR1950320 | |
| 20,00 | 92 | GDMK12CG2000092 | | RDMK12CR2000092 | |
| 20,00 | 100 | GDMK12CG2000100 | | RDMK12CR2000100 | |
| 20,00 | 104 | GDMK12CG2000104 | | RDMK12CR2000104 | |
| 20,00 | 110 | GDMK12CG2000110 | | RDMK12CR2000110 | |
| 20,00 | 120 | GDMK12CG2000120 | | RDMK12CR2000120 | |
| 20,00 | 130 | GDMK12CG2000130 | | RDMK12CR2000130 | |
| 20,00 | 150 | GDMK12CG2000150 | | RDMK12CR2000150 | |
| 20,00 | 165 | GDMK12CG2000165 | | RDMK12CR2000165 | |
| 20,00 | 320 | GSMK12CG2000320 | | RSMK12CR2000320 | |
| 20,50 | 320 | GSMK12CG2000320 | | RSMK12CR2000320 | |
| 21,00 | 100 | GDMK12CG2100100 | | RDMK12CR2100100 | |
| 21,00 | 320 | GSMK12CG2100320 | | RSMK12CR2100320 | |
| 21,50 | 320 | GSMK12CG2150320 | | RSMK12CR2150320 | |
| 22,00 | 100 | GDMK12CG2200100 | | RDMK12CR2200100 | |
| 22,00 | 110 | GDMK12CG2200110 | | RDMK12CR2200110 | |
| 22,00 | 130 | GDMK12CG2200130 | | RDMK12CR2200130 | |
| 22,00 | 150 | GDMK12CG2200150 | | RDMK12CR2200150 | |
| 22,00 | 320 | GSMK12CG2200320 | | RSMK12CR2200320 | |
| 22,50 | 320 | GSMK12CG2250320 | | RSMK12CR2250320 | |
| 23,00 | 100 | GDMK12CG2300100 | | RDMK12CR2300100 | |
| 23,00 | 320 | GSMK12CG2300320 | | RSMK12CR2300320 | |
| 23,50 | 320 | GSMK12CG2350320 | | RSMK12CR2350320 | |

| | | | | | |
|-------|-----|-----------------|--|-----------------|--|
| 24,00 | 100 | GDMK12CG2400100 | | RDMK12CR2400100 | |
| 24,00 | 110 | GDMK12CG2400110 | | RDMK12CR2400110 | |
| 24,00 | 130 | GDMK12CG2400130 | | RDMK12CR2400130 | |
| 24,00 | 320 | GSMK12CG2400320 | | RSMK12CR2400320 | |
| 24,50 | 320 | GSMK12CG2450320 | | RSMK12CR2450320 | |
| 25,00 | 100 | GDMK12CG2500100 | | RDMK12CR2500100 | |
| 25,00 | 110 | GDMK12CG2500110 | | RDMK12CR2500110 | |
| 25,00 | 130 | GDMK12CG2500130 | | RDMK12CR2500130 | |
| 25,00 | 150 | GDMK12CG2500150 | | RDMK12CR2500150 | |
| 25,00 | 320 | GSMK12CG2500320 | | RSMK12CR2500320 | |
| 25,40 | 320 | GSMK12CG2540320 | | RSMK12CR2540320 | |
| 26,00 | 100 | GDMK12CG2600100 | | RDMK12CR2600100 | |
| 26,00 | 110 | GDMK12CG2600110 | | RDMK12CR2600110 | |
| 26,00 | 130 | GDMK12CG2600130 | | RDMK12CR2600130 | |
| 26,00 | 150 | GDMK12CG2600150 | | RDMK12CR2600150 | |
| 26,00 | 320 | GSMK12CG2600320 | | RSMK12CR2600320 | |
| 27,00 | 320 | GSMK12CG2700320 | | RSMK12CR2700320 | |
| 28,00 | 130 | GDMK12CG2800130 | | RDMK12CR2800130 | |
| 28,00 | 320 | GSMK12CG2800320 | | RSMK12CR2800320 | |
| 29,00 | 320 | GSMK12CG2900320 | | RSMK12CR2900320 | |
| 30,00 | 130 | GDMK12CG3000130 | | RDMK12CR3000130 | |
| 30,00 | 150 | GDMK12CG3000150 | | RDMK12CR3000150 | |
| 30,00 | 320 | GSMK12CG3000320 | | RSMK12CR3000320 | |
| 31,00 | 320 | GSMK12CG3100320 | | RSMK12CR3100320 | |
| 32,00 | 130 | GDMK12CG3200130 | | RDMK12CR3200130 | |
| 32,00 | 150 | GDMK12CG3200150 | | RDMK12CR3200150 | |
| 32,00 | 320 | GSMK12CG3200320 | | RSMK12CR3200320 | |
| 33,00 | 320 | GSMK12CG3300320 | | RSMK12CR3300320 | |
| 34,00 | 320 | GSMK12CG3400320 | | RSMK12CR3400320 | |
| 35,00 | 320 | GSMK12CG3500320 | | RSMK12CR3500320 | |
| 36,00 | 320 | GSMK12CG3600320 | | RSMK12CR3600320 | |
| 37,00 | 320 | GSMK12CG3700320 | | RSMK12CR3700320 | |
| 38,00 | 320 | GSMK12CG3800320 | | RSMK12CR3800320 | |
| 39,00 | 320 | GSMK12CG3900320 | | RSMK12CR3900320 | |
| 40,00 | 320 | GSMK12CG4000320 | | RSMK12CR4000320 | |
| 45,00 | 320 | GSMK12CG4500320 | | RSMK12CR4500320 | |

带凹槽的实心硬质合金圆棒

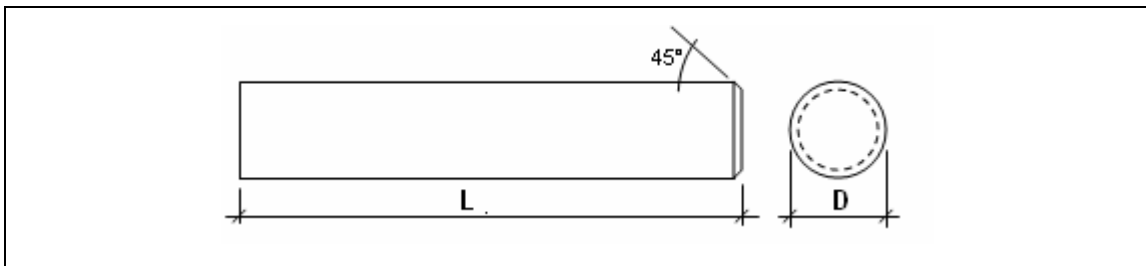

| | | K10F | | | |
|----------|----------|-----------------|--|------------------|--|
| 直径 mm | 长度 mm | 不精磨 | | 精磨 _{h6} | |
| 3,00 | 38 | K10FCG0300038SM | | K10FCR0300038SM | |
| 4,00 | 40 | K10FCG0400040SM | | K10FCR0400040SM | |
| 4,00 | 50 | K10FCG0400050SM | | K10FCR0400050SM | |
| 5,00 | 50 | K10FCG0500050SM | | K10FCR0500050SM | |
| 6,00 | 50 | K10FCG0600050SM | | K10FCR0600050SM | |
| 6,00 | 57 | K10FCG0600057SM | | K10FCR0600057SM | |
| 6,00 | 75 | K10FCG0600075SM | | K10FCR0600075SM | |
| 8,00 | 63 | K10FCG0800063SM | | K10FCR0800063SM | |
| 8,00 | 100 | K10FCG0800100SM | | K10FCR0800100SM | |
| 10,00 | 72 | K10FCG1000072SM | | K10FCR1000072SM | |
| 10,00 | 75 | K10FG1000075SM | | K10FCR1000075SM | |
| 10,00 | 100 | K10FCG1000100SM | | K10FCR1000100SM | |
| 12,00 | 83 | K10FCG1200083SM | | K10FCR1200083SM | |
| 12,00 | 150 | K10FCG1200150SM | | K10FCR1200150SM | |
| 14,00 | 82 | K10FCG1400082SM | | K10FCR1400082SM | |
| 16,00 | 82 | K10FCG1600082SM | | K10FCR1600082SM | |
| 16,00 | 92 | K10FCG1600092SM | | K10FCR1600092SM | |
| 16,00 | 150 | K10FCG1600150SM | | K10FCR1600150SM | |
| 18,00 | 92 | K10FCG1800092SM | | K10FCR1800092SM | |
| 20,00 | 104 | K10FCG2000104SM | | K10FCR2000104SM | |
| 20,00 | 110 | K10FCG2000110SM | | K10FCR2000110SM | |
| 20,00 | 150 | K10FCG2000150SM | | K10FCR2000150SM | |

实心硬质合金圆棒_{330mm}长

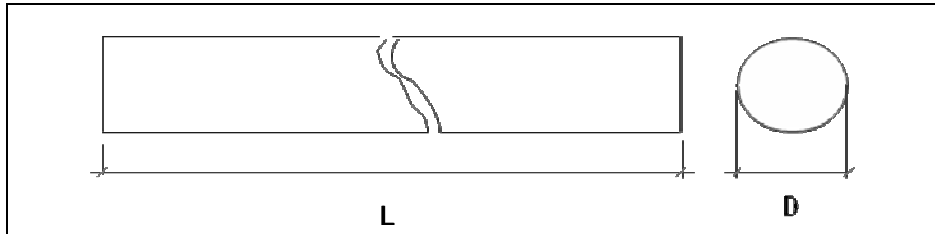

| 牌号 | GF70 | | | |
|--------------|-----------------|-----|-----------------|--|
| | 直径 mm | 不精磨 | 精磨h6 | |
| 3,00 | GSGF70CG0300330 | | RSGF70CR0300330 | |
| 4,00 | GSGF70CG0400330 | | RSGF70CR0400330 | |
| 5,00 | GSGF70CG0500330 | | RSGF70CR0500330 | |
| 6,00 | GSGF70CG0600330 | | RSGF70CR0600330 | |
| 7,00 | GSGF70CG0700330 | | RSGF70CR0700330 | |
| 8,00 | GSGF70CG0800330 | | RSGF70CR0800330 | |
| 9,00 | GSGF70CG0900330 | | RSGF70CR0900330 | |
| 10,00 | GSGF70CG1000330 | | RSGF70CR1000330 | |
| 12,00 | GSGF70CG1200330 | | RSGF70CR1200330 | |
| 14,00 | GSGF70CG1400330 | | RSGF70CR1400330 | |
| 16,00 | GSGF70CG1600330 | | RSGF70CR1600330 | |
| 18,00 | GSGF70CG1800330 | | RSGF70CR1800330 | |
| 20,00 | GSGF70CG2000330 | | RSGF70CR2000330 | |
| 22,00 | GSGF70CG2200330 | | RSGF70CR2200330 | |
| 24,00 | GSGF70CG2400330 | | RSGF70CR2400330 | |
| 26,00 | GSGF70CG2600330 | | RSGF70CR2600330 | |
| 28,00 | GSGF70CG2800330 | | RSGF70CR2800330 | |
| 30,00 | GSGF70CG3000330 | | RSGF70CR3000330 | |
| 32,00 | GSGF70CG3200330 | | RSGF70CR3200330 | |

单直孔硬质合金棒材

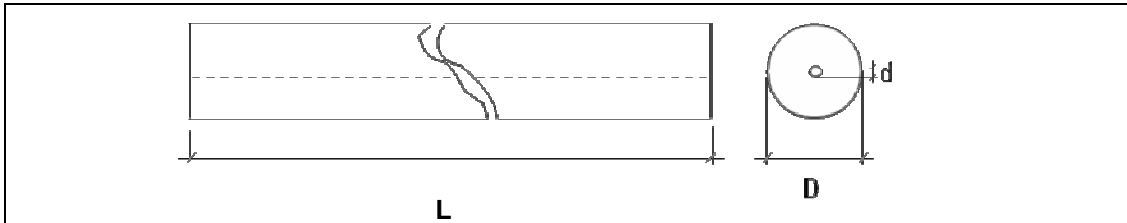

| 牌号 | | K10F | | | |
|------|-----|-------------------|--|-------------------|--|
| 直径 | 直径 | 不精磨 | | 精磨 _{h6} | |
| mm | mm | | | | |
| 4,0 | 0,6 | GCK10FCG040320F06 | | RCK10FCR040320F06 | |
| 6,0 | 1,0 | GCK10FCG060320F10 | | RCK10FCR060320F10 | |
| 8,0 | 1,3 | GCK10FCG080320F13 | | RCK10FCR080320F13 | |
| 10,0 | 2,0 | GCK10FCG100320F20 | | RCK10FCR100320F20 | |
| 12,0 | 2,0 | GCK10FCG120320F20 | | RCK10FCR120320F20 | |
| 14,0 | 2,0 | GCK10FCG140320F20 | | RCK10FCR140320F20 | |
| 16,0 | 3,0 | GCK10FCG160320F30 | | RCK10FCR160320F30 | |
| 18,0 | 3,0 | GCK10FCG180320F30 | | RCK10FCR180320F30 | |
| 20,0 | 3,0 | GCK10FCG200320F30 | | RCK10FCR200320F30 | |
| 22,0 | 3,0 | GCK10FCG220320F30 | | RCK10FCR220320F30 | |
| 24,0 | 4,0 | GCK10FCG240320F40 | | RCK10FCR240320F40 | |
| 25,0 | 4,0 | GCK10FCG250320F40 | | RCK10FCR250320F40 | |
| 26,0 | 4,0 | GCK10FCG260320F40 | | RCK10FCR260320F40 | |
| 28,0 | 4,0 | GCK10FCG280320F40 | | RCK10FCR280320F40 | |
| 30,0 | 5,0 | GCK10FCG300320F50 | | RCK10FCR300320F50 | |
| 32,0 | 5,0 | GCK10FCG320320F50 | | RCK10FCR320320F50 | |
| 34,0 | 5,0 | GCK10FCG340320F50 | | RCK10FCR340320F50 | |
| 35,0 | 6,0 | GCK10FCG350320F60 | | RCK10FCR350320F60 | |
| 36,0 | 6,0 | GCK10FCG360320F60 | | RCK10FCR360320F60 | |

单直孔硬质合金棒材

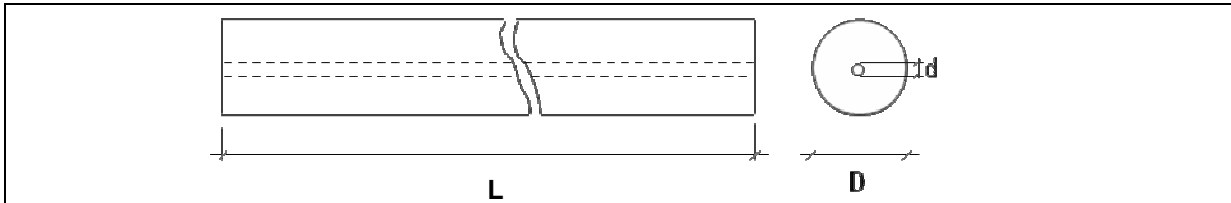

| 牌号 | | MK12 | | | |
|------|-----|-------------------|--|-------------------|--|
| 直径 | 直径 | 不精磨 | | 精磨 _{h6} | |
| mm | mm | | | | |
| 4,0 | 0,6 | GCMK12CG040320F06 | | RCMK12CR040320F06 | |
| 6,0 | 1,0 | GCMK12CG060320F10 | | RCMK12CR060320F10 | |
| 8,0 | 1,3 | GCMK12CG080320F13 | | RCMK12CR080320F13 | |
| 10,0 | 2,0 | GCMK12CG100320F20 | | RCMK12CR100320F20 | |
| 12,0 | 2,0 | GCMK12CG120320F20 | | RCMK12CR120320F20 | |
| 14,0 | 2,0 | GCMK12CG140320F20 | | RCMK12CR140320F20 | |
| 16,0 | 3,0 | GCMK12CG160320F30 | | RCMK12CR160320F30 | |
| 18,0 | 3,0 | GCMK12CG180320F30 | | RCMK12CR180320F30 | |
| 20,0 | 3,0 | GCMK12CG200320F30 | | RCMK12CR200320F30 | |
| 22,0 | 3,0 | GCMK12CG220320F30 | | RCMK12CR220320F30 | |
| 24,0 | 4,0 | GCMK12CG240320F40 | | RCMK12CR240320F40 | |
| 25,0 | 4,0 | GCMK12CG250320F40 | | RCMK12CR250320F40 | |
| 26,0 | 4,0 | GCMK12CG260320F40 | | RCMK12CR260320F40 | |
| 28,0 | 4,0 | GCMK12CG280320F40 | | RCMK12CR280320F40 | |
| 30,0 | 5,0 | GCMK12CG300320F50 | | RCMK12CR300320F50 | |
| 32,0 | 5,0 | GCMK12CG320320F50 | | RCMK12CR320320F50 | |
| 34,0 | 5,0 | GCMK12CG340320F50 | | RCMK12CR340320F50 | |
| 35,0 | 6,0 | GCMK12CG350320F60 | | RCMK12CR350320F60 | |
| 36,0 | 6,0 | GCMK12CG360320F60 | | RCMK12CR360320F60 | |

单直孔硬质合金棒材

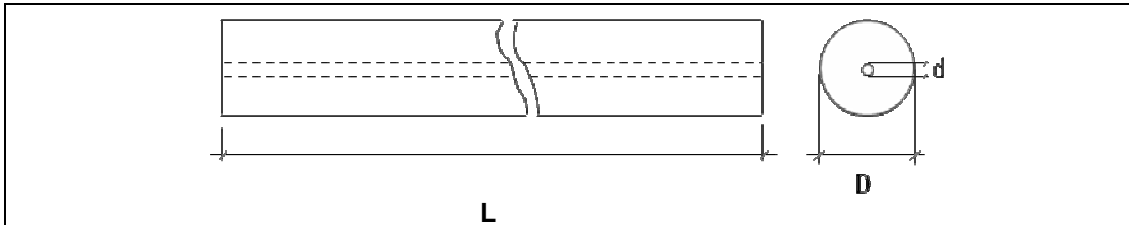

| 牌号 | | GF70 | | | |
|------|-----|-------------------|--|-------------------|--|
| 直径 | 直径 | 不精磨 | | 精磨 _{h6} | |
| mm | mm | | | | |
| 4,0 | 0,6 | GCGF70CG040330F06 | | RCGF70CR040330F06 | |
| 6,0 | 1,0 | GCGF70CG060330F10 | | RCGF70CR060330F10 | |
| 8,0 | 1,3 | GCGF70CG080330F13 | | RCGF70CR080330F13 | |
| 10,0 | 2,0 | GCGF70CG100330F20 | | RCGF70CR100330F20 | |
| 12,0 | 2,0 | GCGF70CG120330F20 | | RCGF70CR120330F20 | |
| 14,0 | 2,0 | GCGF70CG140330F20 | | RCGF70CR140330F20 | |
| 16,0 | 3,0 | GCGF70CG160330F30 | | RCGF70CR160330F30 | |
| 18,0 | 3,0 | GCGF70CG180330F30 | | RCGF70CR180330F30 | |
| 20,0 | 3,0 | GCGF70CG200330F30 | | RCGF70CR200330F30 | |
| 22,0 | 3,0 | GCGF70CG220330F30 | | RCGF70CR220330F30 | |
| 24,0 | 4,0 | GCGF70CG240330F40 | | RCGF70CR240330F40 | |
| 25,0 | 4,0 | GCGF70CG250330F40 | | RCGF70CR250330F40 | |
| 26,0 | 4,0 | GCGF70CG260330F40 | | RCGF70CR260330F40 | |
| 28,0 | 4,0 | GCGF70CG280330F40 | | RCGF70CR280330F40 | |
| 30,0 | 5,0 | GCGF70CG300330F50 | | RCGF70CR300330F50 | |
| 32,0 | 5,0 | GCGF70CG320330F50 | | RCGF70CR320330F50 | |
| 34,0 | 5,0 | GCGF70CG340330F50 | | RCGF70CR340330F50 | |
| 35,0 | 6,0 | GCGF70CG350330F60 | | RCGF70CR350330F60 | |
| 36,0 | 6,0 | GCGF70CG360330F60 | | RCGF70CR360330F60 | |

双直孔硬质合金棒材

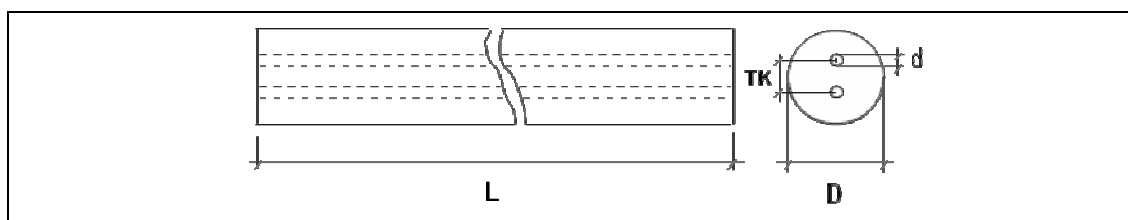

| 牌号 | | | K10F | | | |
|------|-----|------|------------------|--|------------------|--|
| 直径 | 直径 | TK | 不精磨 | | 精磨 _{h6} | |
| mm | mm | mm | | | | |
| 6,0 | 0,8 | 2,0 | GPK10FCG060320FS | | RPK10FCR060320FS | |
| 6,0 | 1,0 | 3,0 | GPK10FCG060320FL | | RPK10FCR060320FL | |
| 8,0 | 1,0 | 2,0 | GPK10FCG080320FS | | RPK10FCR080320FS | |
| 8,0 | 1,0 | 4,0 | GPK10FCG080320FL | | RPK10FCR080320FL | |
| 10,0 | 1,0 | 3,0 | GPK10FCG100320FS | | RPK10FCR100320FS | |
| 10,0 | 1,3 | 5,0 | GPK10FCG100320FL | | RPK10FCR100320FL | |
| 11,0 | 1,4 | 5,0 | GPK10FCG110320FL | | RPK10FCR110320FL | |
| 12,0 | 1,3 | 3,8 | GPK10FCG120320FS | | RPK10FCR120320FS | |
| 12,0 | 1,4 | 6,0 | GPK10FCG120320FL | | RPK10FCR120320FL | |
| 13,0 | 1,4 | 6,0 | GPK10FCG130320FL | | RPK10FCR130320FL | |
| 14,0 | 1,7 | 5,0 | GPK10FCG140320FS | | RPK10FCR140320FS | |
| 14,0 | 1,8 | 7,0 | GPK10FCG140320FL | | RPK10FCR140320FL | |
| 15,0 | 1,8 | 7,0 | GPK10FCG150320FL | | RPK10FCR150320FL | |
| 16,0 | 1,7 | 5,0 | GPK10FCG160320FS | | RPK10FCR160320FS | |
| 16,0 | 1,8 | 8,0 | GPK10FCG160320FL | | RPK10FCR160320FL | |
| 17,0 | 2,0 | 8,0 | GPK10FCG170320FL | | RPK10FCR170320FL | |
| 18,0 | 2,0 | 6,0 | GPK10FCG180320FS | | RPK10FCR180320FS | |
| 18,0 | 2,0 | 9,0 | GPK10FCG180320FL | | RPK10FCR180320FL | |
| 20,0 | 2,0 | 10,0 | GPK10FCG200320FL | | RPK10FCR200320FL | |
| 22,0 | 2,5 | 11,0 | GPK10FCG220320FL | | RPK10FCR220320FL | |
| 24,0 | 2,5 | 12,0 | GPK10FCG240320FL | | RPK10FCR240320FL | |
| 25,0 | 3,0 | 12,0 | GPK10FCG250320FL | | RPK10FCR250320FL | |
| 28,0 | 3,0 | 14,0 | GPK10FCG280320FL | | RPK10FCR280320FL | |
| 30,0 | 3,0 | 14,0 | GPK10FCG300320FL | | RPK10FCR300320FL | |
| 32,0 | 3,0 | 14,0 | GPK10FCG320320FL | | RPK10FCR320320FL | |
| 35,0 | 3,0 | 14,0 | GPK10FCG350320FL | | RPK10FCR350320FL | |

双直孔硬质合金棒材

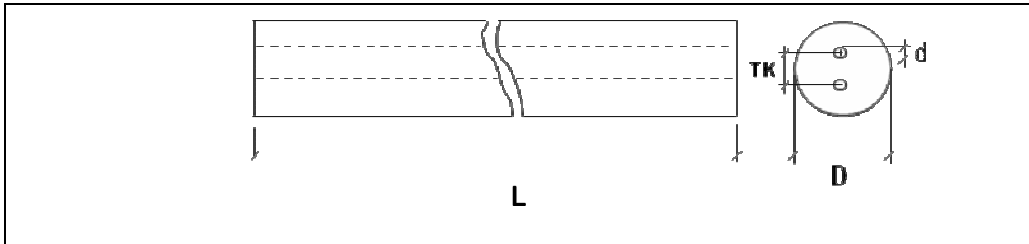

| 牌号 | | | MK12 | | | |
|------|-----|------|------------------|--|------------------|--|
| 直径 | 直径 | TK | 不精磨 | | 精磨 _{h6} | |
| mm | mm | mm | | | | |
| 6,0 | 0,8 | 2,0 | GPMK12CG060320FS | | RPMK12CR060320FS | |
| 6,0 | 1,0 | 3,0 | GPMK12CG060320FL | | RPMK12CR060320FL | |
| 8,0 | 1,0 | 2,0 | GPMK12CG080320FS | | RPMK12CR080320FS | |
| 8,0 | 1,0 | 4,0 | GPMK12CG080320FL | | RPMK12CR080320FL | |
| 10,0 | 1,0 | 3,0 | GPMK12CG100320FS | | RPMK12CR100320FS | |
| 10,0 | 1,3 | 5,0 | GPMK12CG100320FL | | RPMK12CR100320FL | |
| 11,0 | 1,4 | 5,0 | GPMK12CG110320FL | | RPMK12CR110320FL | |
| 12,0 | 1,3 | 3,8 | GPMK12CG120320FS | | RPMK12CR120320FS | |
| 12,0 | 1,4 | 6,0 | GPMK12CG120320FL | | RPMK12CR120320FL | |
| 13,0 | 1,4 | 6,0 | GPMK12CG130320FL | | RPMK12CR130320FL | |
| 14,0 | 1,7 | 5,0 | GPMK12CG140320FS | | RPMK12CR140320FS | |
| 14,0 | 1,8 | 7,0 | GPMK12CG140320FL | | RPMK12CR140320FL | |
| 15,0 | 1,8 | 7,0 | GPMK12CG150320FL | | RPMK12CR150320FL | |
| 16,0 | 1,7 | 5,0 | GPMK12CG160320FS | | RPMK12CR160320FS | |
| 16,0 | 1,8 | 8,0 | GPMK12CG160320FL | | RPMK12CR160320FL | |
| 17,0 | 2,0 | 8,0 | GPMK12CG170320FL | | RPMK12CR170320FL | |
| 18,0 | 2,0 | 6,0 | GPMK12CG180320FS | | RPMK12CR180320FS | |
| 18,0 | 2,0 | 9,0 | GPMK12CG180320FL | | RPMK12CR180320FL | |
| 20,0 | 2,0 | 10,0 | GPMK12CG200320FL | | RPMK12CR200320FL | |
| 22,0 | 2,5 | 11,0 | GPMK12CG220320FL | | RPMK12CR220320FL | |
| 24,0 | 2,5 | 12,0 | GPMK12CG240320FL | | RPMK12CR240320FL | |
| 25,0 | 3,0 | 12,0 | GPMK12CG250320FL | | RPMK12CR250320FL | |
| 28,0 | 3,0 | 14,0 | GPMK12CG280320FL | | RPMK12CR280320FL | |
| 30,0 | 3,0 | 14,0 | GPMK12CG300320FL | | RPMK12CR300320FL | |
| 32,0 | 3,0 | 14,0 | GPMK12CG320320FL | | RPMK12CR320320FL | |
| 35,0 | 3,0 | 14,0 | GPMK12CG350320FL | | RPMK12CR350320FL | |

双直孔硬质合金棒材

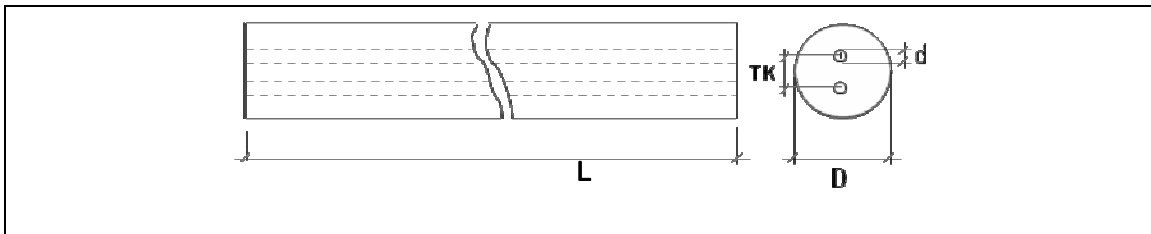

| 牌号 | | | GF70 | | | |
|------|-----|------|------------------|--|------------------|--|
| 直径 | 直径 | TK | 不精磨 | | 精磨 _{h6} | |
| mm | mm | mm | | | | |
| 6,0 | 0,8 | 2,0 | GPGF70CG060330FS | | RPGF70CR060330FS | |
| 6,0 | 1,0 | 3,0 | GPGF70CG060330FL | | RPGF70CR060330FL | |
| 8,0 | 1,0 | 2,0 | GPGF70CG080330FS | | RPGF70CR080330FS | |
| 8,0 | 1,0 | 4,0 | GPGF70CG080330FL | | RPGF70CR080330FL | |
| 10,0 | 1,0 | 3,0 | GPGF70CG100330FS | | RPGF70CR100330FS | |
| 10,0 | 1,3 | 5,0 | GPGF70CG100330FL | | RPGF70CR100330FL | |
| 11,0 | 1,4 | 5,0 | GPGF70CG110330FL | | RPGF70CR110330FL | |
| 12,0 | 1,3 | 3,8 | GPGF70CG120330FS | | RPGF70CR120330FS | |
| 12,0 | 1,4 | 6,0 | GPGF70CG120330FL | | RPGF70CR120330FL | |
| 13,0 | 1,4 | 6,0 | GPGF70CG130330FL | | RPGF70CR130330FL | |
| 14,0 | 1,7 | 5,0 | GPGF70CG140330FS | | RPGF70CR140330FS | |
| 14,0 | 1,8 | 7,0 | GPGF70CG140330FL | | RPGF70CR140330FL | |
| 15,0 | 1,8 | 7,0 | GPGF70CG150330FL | | RPGF70CR150330FL | |
| 16,0 | 1,7 | 5,0 | GPGF70CG160330FS | | RPGF70CR160330FS | |
| 16,0 | 1,8 | 8,0 | GPGF70CG160330FL | | RPGF70CR160330FL | |
| 17,0 | 2,0 | 8,0 | GPGF70CG170330FL | | RPGF70CR170330FL | |
| 18,0 | 2,0 | 6,0 | GPGF70CG180330FS | | RPGF70CR180330FS | |
| 18,0 | 2,0 | 9,0 | GPGF70CG180330FL | | RPGF70CR180330FL | |
| 20,0 | 2,0 | 10,0 | GPGF70CG200330FL | | RPGF70CR200330FL | |
| 22,0 | 2,5 | 11,0 | GPGF70CG220330FL | | RPGF70CR220330FL | |
| 24,0 | 2,5 | 12,0 | GPGF70CG240330FL | | RPGF70CR240330FL | |
| 25,0 | 3,0 | 12,0 | GPGF70CG250330FL | | RPGF70CR250330FL | |
| 28,0 | 3,0 | 14,0 | GPGF70CG280330FL | | RPGF70CR280330FL | |
| 30,0 | 3,0 | 14,0 | GPGF70CG300330FL | | RPGF70CR300330FL | |
| 32,0 | 3,0 | 14,0 | GPGF70CG320330FL | | RPGF70CR320330FL | |
| 35,0 | 3,0 | 14,0 | GPGF70CG350330FL | | RPGF70CR350330FL | |

双螺旋孔硬质合金棒材 330mm 长

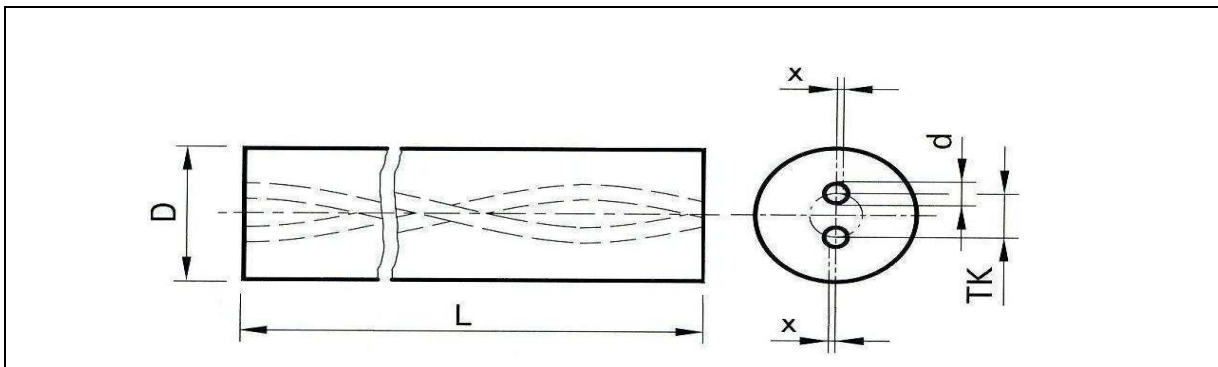

冷却管道30°

| 牌号 | | | K10F | | | |
|-------|------|-------|--------------------|--|--------------------|--|
| 直径 | 直径 | TK | 不精磨 | | 精磨 _{h6} | |
| mm | mm | mm | | | | |
| 6,00 | 0,70 | 2,60 | K10FCG0603302FLE30 | | K10FCR0603302FLE30 | |
| 8,00 | 1,00 | 4,00 | K10FCG0803302FLE30 | | K10FCR0803302FLE30 | |
| 10,00 | 1,40 | 4,80 | K10FCG1003302FLE30 | | K10FCR1003302FLE30 | |
| 12,00 | 1,40 | 6,25 | K10FCG1203302FLE30 | | K10FCR1203302FLE30 | |
| 14,00 | 1,75 | 7,10 | K10FCG1403302FLE30 | | K10FCR1403302FLE30 | |
| 16,00 | 1,75 | 8,30 | K10FCG1603302FLE30 | | K10FCR1603302FLE30 | |
| 18,00 | 2,30 | 9,00 | K10FCG1803302FLE30 | | K10FCR1803302FLE30 | |
| 20,00 | 2,50 | 10,00 | K10FCG2003302FLE30 | | K10FCR2003302FLE30 | |
| 22,00 | 2,50 | 10,00 | K10FCG2203302FLE30 | | K10FCR2203302FLE30 | |
| 24,00 | 2,50 | 12,00 | K10FCG2403302FLE30 | | K10FCR2403302FLE30 | |
| 26,00 | 2,50 | 12,00 | K10FCG2603302FLE30 | | K10FCR2603302FLE30 | |

冷却管道40°

| 牌号 | | | K10F | | | |
|----------|----------|----------|--------------------|--|--------------------|--|
| 直径 mm | 直径 mm | TK mm | 不精磨 | | 精磨 _{h6} | |
| 6,00 | 0,50 | 2,20 | K10FCG0603302FLE40 | | K10FCR0603302FLE40 | |
| 8,00 | 0,65 | 2,70 | K10FCG0803302FLE40 | | K10FCR0803302FLE40 | |
| 10,00 | 0,80 | 3,50 | K10FCG1003302FLE40 | | K10FCR1003302FLE40 | |
| 12,00 | 0,90 | 4,20 | K10FCG1203302FLE40 | | K10FCR1203302FLE40 | |
| 14,00 | 1,00 | 4,70 | K10FCG1403302FLE40 | | K10FCR1403302FLE40 | |
| 16,00 | 1,20 | 5,50 | K10FCG1603302FLE40 | | K10FCR1603302FLE40 | |
| 18,00 | 1,40 | 6,30 | K10FCG1803302FLE40 | | K10FCR1803302FLE40 | |
| 20,00 | 1,50 | 7,10 | K10FCG2003302FLE40 | | K10FCR2003302FLE40 | |
| 22,00 | 1,70 | 7,70 | K10FCG2203302FLE40 | | K10FCR2203302FLE40 | |
| 24,00 | 1,75 | 8,00 | K10FCG2403302FLE40 | | K10FCR2403302FLE40 | |
| 26,00 | 1,75 | 8,20 | K10FCG2603302FLE40 | | K10FCR2603302FLE40 | |

铰刀坯

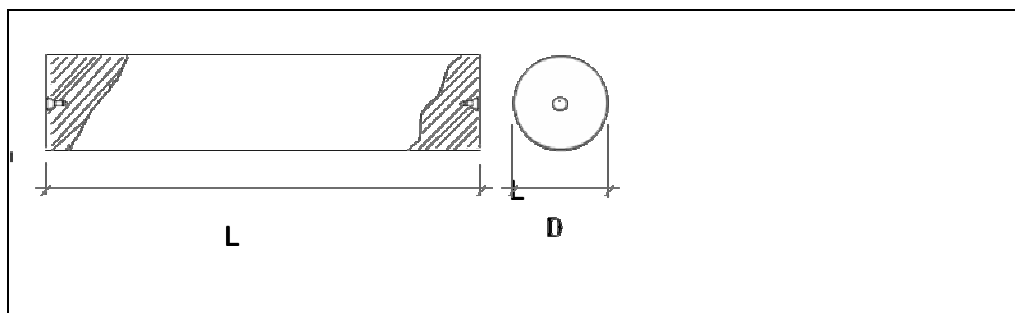

| 牌号 | | K10F | |
|-------|-----|--------------|--|
| 直径 | 长度 | 不精磨 | |
| mm | mm | | |
| 4,00 | 75 | K10FCA040075 | |
| 4,50 | 80 | K10FCA045080 | |
| 5,00 | 86 | K10FCA050086 | |
| 5,50 | 93 | K10FCA055093 | |
| 6,00 | 93 | K10FCA060093 | |
| 6,50 | 101 | K10FCA065101 | |
| 7,00 | 109 | K10FCA070109 | |
| 7,50 | 109 | K10FCA075109 | |
| 8,00 | 117 | K10FCA080117 | |
| 8,50 | 117 | K10FCA085117 | |
| 9,00 | 125 | K10FCA090125 | |
| 9,50 | 125 | K10FCA095125 | |
| 10,00 | 133 | K10FCA100133 | |
| 10,50 | 133 | K10FCA105133 | |
| 11,00 | 142 | K10FCA110142 | |
| 11,50 | 142 | K10FCA115142 | |
| 12,00 | 151 | K10FCA120151 | |
| 12,50 | 151 | K10FCA125151 | |
| 13,00 | 151 | K10FCA130151 | |
| 13,50 | 160 | K10FCA135160 | |
| 14,00 | 160 | K10FCA140160 | |
| 14,50 | 169 | K10FCA145169 | |
| 15,00 | 169 | K10FCA150169 | |
| 15,50 | 178 | K10FCA155178 | |
| 16,00 | 178 | K10FCA160178 | |

硬质合金长条

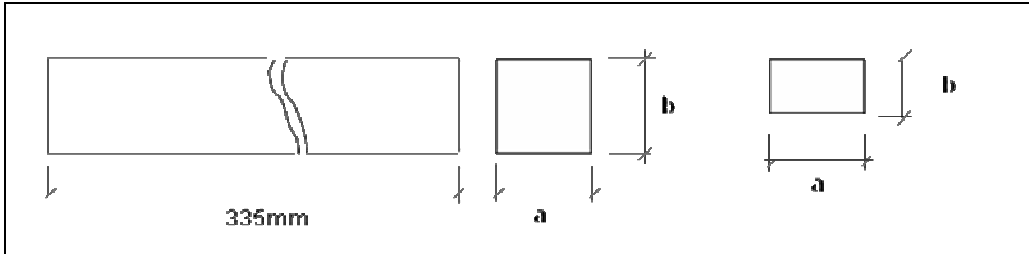

| 牌号 | | K10F | | K30 | |
|---------|---------|----------------|--|---------------|--|
| a mm | b mm | 项代码 | | 项代码 | |
| 1,5 | 3 | K10FB01.503335 | | K30B01.503335 | |
| 1,5 | 4 | K10FB01.504335 | | K30B01.504335 | |
| 1,5 | 6 | K10FB01.506335 | | K30B01.506335 | |
| 1,5 | 8 | K10FB01.508335 | | K30B01.508335 | |
| 2,0 | 2 | K10FB02.002335 | | K30B02.002335 | |
| 2,0 | 4 | K10FB02.004335 | | K30B02.004335 | |
| 2,0 | 5 | K10FB02.005335 | | K30B02.005335 | |
| 2,0 | 6 | K10FB02.006335 | | K30B02.006335 | |
| 2,0 | 7 | K10FB02.007335 | | K30B02.007335 | |
| 2,0 | 8 | K10FB02.008335 | | K30B02.008335 | |
| 2,0 | 9 | K10FB02.009335 | | K30B02.009335 | |
| 2,0 | 10 | K10FB02.010335 | | K30B02.010335 | |
| 2,0 | 12 | K10FB02.012335 | | K30B02.012335 | |
| 2,0 | 14 | K10FB02.014335 | | K30B02.014335 | |
| 2,0 | 16 | K10FB02.016335 | | K30B02.016335 | |
| 2,0 | 18 | K10FB02.018335 | | K30B02.018335 | |
| 2,0 | 20 | K10FB02.020335 | | K30B02.020335 | |
| 2,5 | 6 | K10FB02.506335 | | K30B02.506335 | |
| 2,5 | 8 | K10FB02.508335 | | K30B02.508335 | |
| 2,5 | 10 | K10FB02.510335 | | K30B02.510335 | |
| 2,5 | 12 | K10FB02.512335 | | K30B02.512335 | |
| 2,5 | 14 | K10FB02.514335 | | K30B02.514335 | |
| 2,5 | 16 | K10FB02.516335 | | K30B02.516335 | |
| 2,5 | 18 | K10FB02.518335 | | K30B02.518335 | |
| 2,5 | 20 | K10FB02.520335 | | K30B02.520335 | |
| 3,0 | 3 | K10FB03.003335 | | K30B03.003335 | |
| 3,0 | 5 | K10FB03.005335 | | K30B03.005335 | |
| 3,0 | 6 | K10FB03.006335 | | K30B03.006335 | |
| 3,0 | 7 | K10FB03.007335 | | K30B03.007335 | |

| | | | | | |
|------|----|----------------|--|---------------|--|
| 3,0 | 8 | K10FB03.008335 | | K30B03.008335 | |
| 3,0 | 10 | K10FB03.010335 | | K30B03.010335 | |
| 3,0 | 12 | K10FB03.012335 | | K30B03.012335 | |
| 3,0 | 13 | K10FB03.013335 | | K30B03.013335 | |
| 3,0 | 14 | K10FB03.014335 | | K30B03.014335 | |
| 3,0 | 15 | K10FB03.015335 | | K30B03.015335 | |
| 3,0 | 16 | K10FB03.016335 | | K30B03.016335 | |
| 3,0 | 18 | K10FB03.018335 | | K30B03.018335 | |
| 3,0 | 20 | K10FB03.020335 | | K30B03.020335 | |
| 3,0 | 22 | K10FB03.022335 | | K30B03.022335 | |
| 3,0 | 25 | K10FB03.025335 | | K30B03.025335 | |
| 3,0 | 30 | K10FB03.030335 | | K30B03.030335 | |
| 4,0 | 4 | K10FB04.004335 | | K30B04.004335 | |
| 4,0 | 5 | K10FB04.005335 | | K30B04.005335 | |
| 4,0 | 6 | K10FB04.006335 | | K30B04.006335 | |
| 4,0 | 8 | K10FB04.008335 | | K30B04.008335 | |
| 4,0 | 10 | K10FB04.010335 | | K30B04.010335 | |
| 4,0 | 12 | K10FB04.012335 | | K30B04.012335 | |
| 4,0 | 13 | K10FB04.013335 | | K30B04.013335 | |
| 4,0 | 14 | K10FB04.014335 | | K30B04.014335 | |
| 4,0 | 16 | K10FB04.016335 | | K30B04.016335 | |
| 4,0 | 18 | K10FB04.018335 | | K30B04.018335 | |
| 4,0 | 20 | K10FB04.020335 | | K30B04.020335 | |
| 4,0 | 22 | K10FB04.022335 | | K30B04.022335 | |
| 4,0 | 25 | K10FB04.025335 | | K30B04.025335 | |
| 4,0 | 30 | K10FB04.030335 | | K30B04.030335 | |
| 5,0 | 5 | K10FB05.005335 | | K30B05.005335 | |
| 5,0 | 7 | K10FB05.007335 | | K30B05.007335 | |
| 5,0 | 8 | K10FB05.008335 | | K30B05.008335 | |
| 5,0 | 10 | K10FB05.010335 | | K30B05.010335 | |
| 5,0 | 12 | K10FB05.012335 | | K30B05.012335 | |
| 5,0 | 14 | K10FB05.014335 | | K30B05.014335 | |
| 5,0 | 16 | K10FB05.016335 | | K30B05.016335 | |
| 5,0 | 18 | K10FB05.018335 | | K30B05.018335 | |
| 5,0 | 20 | K10FB05.020335 | | K30B05.020335 | |
| 5,0 | 25 | K10FB05.025335 | | K30B05.025335 | |
| 5,0 | 30 | K10FB05.030335 | | K30B05.030335 | |
| 5,0 | 32 | K10FB05.032335 | | K30B05.032335 | |
| 6,0 | 6 | K10FB06.006335 | | K30B06.006335 | |
| 6,0 | 8 | K10FB06.008335 | | K30B06.008335 | |
| 6,0 | 10 | K10FB06.010335 | | K30B06.010335 | |
| 6,0 | 12 | K10FB06.012335 | | K30B06.012335 | |
| 6,0 | 14 | K10FB06.014335 | | K30B06.014335 | |
| 6,0 | 16 | K10FB06.016335 | | K30B06.016335 | |
| 6,0 | 18 | K10FB06.018335 | | K30B06.018335 | |
| 6,0 | 20 | K10FB06.020335 | | K30B06.020335 | |
| 6,0 | 25 | K10FB06.025335 | | K30B06.025335 | |
| 6,0 | 30 | K10FB06.030335 | | K30B06.030335 | |
| 8,0 | 8 | K10FB08.008335 | | K30B08.008335 | |
| 10,0 | 10 | K10FB10.010335 | | K30B10.010335 | |
| 12,0 | 12 | K10FB12.012335 | | K30B12.012335 | |
| 14,0 | 14 | K10FB14.014335 | | K30B14.014335 | |
| 16,0 | 16 | K10FB16.016335 | | K30B16.016335 | |
| 18,0 | 18 | K10FB18.018335 | | K30B18.018335 | |
| 20,0 | 20 | K10FB20.020335 | | K30B20.020335 | |

中心钻坯

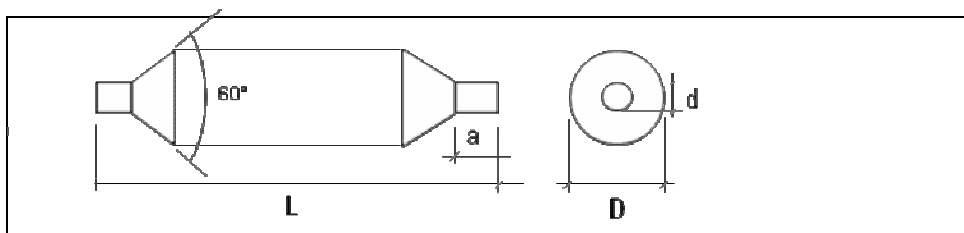

| 牌号 | | | | K10F | |
|----------|------|----------|---------|--------------|--|
| 直径 mm | 长度mm | 直径 mm | a mm | 不精磨 | |
| 4,0 | 35,0 | 1,60 | 2,0 | K10FCPC04035 | |
| 5,0 | 40,0 | 2,00 | 2,5 | K10FCPC05040 | |
| 6,3 | 45,0 | 2,50 | 3,1 | K10FCPC06345 | |
| 8,0 | 50,0 | 3,15 | 3,9 | K10FCPC08050 | |
| 10,0 | 56,0 | 4,00 | 5,0 | K10FCPC10056 | |
| 12,5 | 63,0 | 5,00 | 6,3 | K10FCPC12563 | |
| 16,0 | 71,0 | 6,30 | 8,0 | K10FCPC16071 | |

螺旋边坯

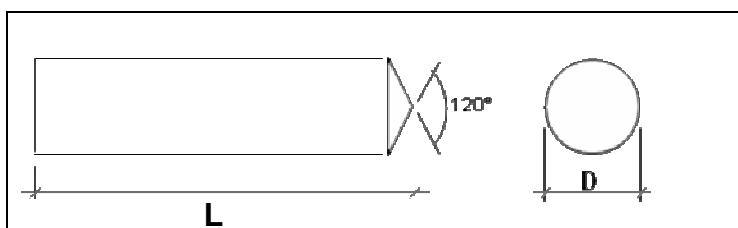

| 牌号 | | K10F | |
|----------|----------|---------------|--|
| 直径 mm | 长度 mm | 项代码 | |
| 4,0 | 55 | K10FCPE040055 | |
| 4,0 | 75 | K10FCPE040075 | |
| 5,0 | 62 | K10FCPE050062 | |
| 5,0 | 86 | K10FCPE050086 | |
| 6,0 | 66 | K10FCPE060066 | |
| 6,0 | 82 | K10FCPE060082 | |
| 6,0 | 93 | K10FCPE060093 | |
| 7,0 | 74 | K10FCPE070074 | |
| 7,0 | 109 | K10FCPE070109 | |
| 8,0 | 79 | K10FCPE080079 | |
| 8,0 | 91 | K10FCPE080091 | |
| 8,0 | 117 | K10FCPE080117 | |
| 9,0 | 84 | K10FCPE090084 | |
| 9,0 | 25 | K10FCPE090125 | |
| 10,0 | 89 | K10FCPE100089 | |
| 10,0 | 103 | K10FCPE100103 | |
| 10,0 | 133 | K10FCPE100133 | |
| 12,0 | 102 | K10FCPE120102 | |
| 12,0 | 118 | K10FCPE120118 | |
| 12,0 | 151 | K10FCPE120151 | |
| 14,0 | 107 | K10FCPE140107 | |
| 14,0 | 124 | K10FCPE140124 | |
| 14,0 | 160 | K10FCPE140160 | |
| 16,0 | 115 | K10FCPE160115 | |
| 16,0 | 133 | K10FCPE160133 | |

旋转锉合金 K30

* K10F牌号根据顾客要求可制造的

| 牌号 | | K10F | K30 |
|----|----------|------|-----|
| 项目 | DIN 8033 | 项代码 | 项代码 |

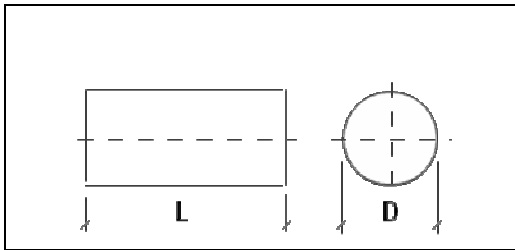

| | | |
|----------------|-------------|------------|
| TLA / ZYA 0410 | K10FTLA0410 | K30TLA0410 |
| TLA / ZYA 0512 | K10FTLA0512 | K30TLA0512 |
| TLA / ZYA 0613 | K10FTLA0613 | K30TLA0613 |
| TLA / ZYA 0820 | K10FTLA0820 | K30TLA0820 |
| TLA / ZYA 1020 | K10FTLA1020 | K30TLA1020 |
| TLA / ZYA 1225 | K10FTLA1225 | K30TLA1225 |
| TLA / ZYA 1625 | K10FTLA1625 | K30TLA1625 |
| TLA / ZYA 2025 | K10FTLA2025 | K30TLA2025 |

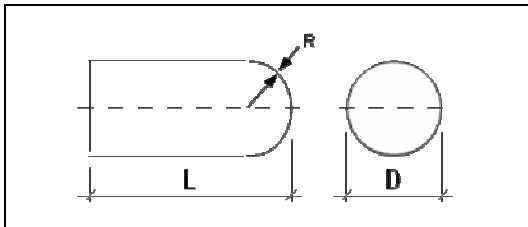

| | | |
|----------------|-------------|------------|
| TLB / WRC 0512 | K10FTLB0512 | K30TLB0512 |
| TLB / WRC 0613 | K10FTLB0613 | K30TLB0613 |
| TLB / WRC 0820 | K10FTLB0820 | K30TLB0820 |
| TLB / WRC 1020 | K10FTLB1020 | K30TLB1020 |
| TLB / WRC 1225 | K10FTLB1225 | K30TLB1225 |
| TLB / WRC 1625 | K10FTLB1625 | K30TLB1625 |
| TLB / WRC 2025 | K10FTLB2025 | K30TLB2025 |

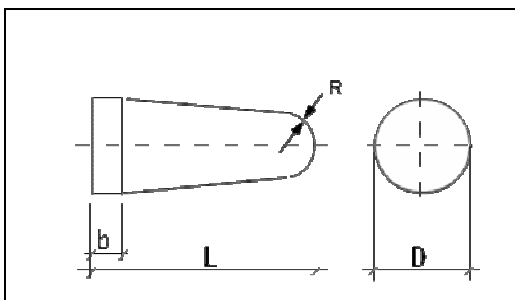

| | | |
|----------------|-------------|------------|
| TLC / KEL 0820 | K10FTLC0820 | K30TLC0820 |
| TLC / KEL 0824 | K10FTLC0824 | K30TLC0824 |
| TLC / KEL 1020 | K10FTLC1020 | K30TLC1020 |
| TLC / KEL 1028 | K10FTLC1028 | K30TLC1028 |
| TLC / KEL 1225 | K10FTLC1225 | K30TLC1225 |
| TLC / KEL 1230 | K10FTLC1230 | K30TLC1230 |
| TLC / KEL 1630 | K10FTLC1630 | K30TLC1630 |
| TLC / KEL 1638 | K10FTLC1638 | K30TLC1638 |
| TLC / KEL 2032 | K10FTLC2032 | K30TLC2032 |

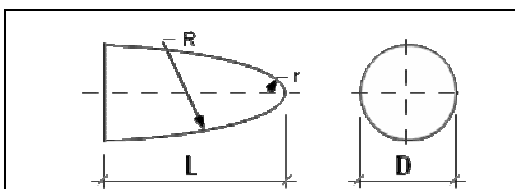

| | | |
|----------------|-------------|------------|
| TLD / RBF 0613 | K10FTLD0613 | K30TLD0613 |
| TLD / RBF 0818 | K10FTLD0818 | K30TLD0818 |
| TLD / RBF 1020 | K10FTLD1020 | K30TLD1020 |
| TLD / RBF 1225 | K10FTLD1225 | K30TLD1225 |
| TLD / RBF 1630 | K10FTLD1630 | K30TLD1630 |
| TLD / RBF 2030 | K10FTLD2030 | K30TLD2030 |

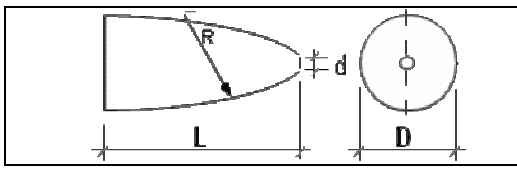

| | | |
|-----------------------|-------------|------------|
| TLE / SPG 0613 | K10FTLE0613 | K30TLE0613 |
| TLE / SPG 0818 | K10FTLE0818 | K30TLE0818 |
| TLE / SPG 1020 | K10FTLE1020 | K30TLE1020 |
| TLE / SPG 1225 | K10FTLE1225 | K30TLE1225 |
| TLE / SPG 1630 | K10FTLE1630 | K30TLE1630 |

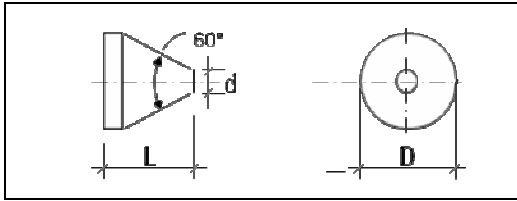

| | | |
|---------------------------|-------------|------------|
| TLF / KSJ 60° 0606 | K10FTLF0606 | K30TLF0606 |
| TLF / KSJ 60° 0808 | K10FTLF0808 | K30TLF0808 |
| TLF / KSJ 60° 1010 | K10FTLF1010 | K30TLF1010 |
| TLF / KSJ 60° 1212 | K10FTLF1212 | K30TLF1212 |
| TLF / KSJ 60° 1616 | K10FTLF1616 | K30TLF1616 |
| TLF / KSJ 60° 2020 | K10FTLF2020 | K30TLF2020 |

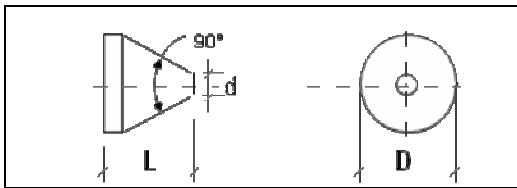

| | | |
|---------------------------|-------------|------------|
| TLG / KSK 90° 0605 | K10FTLG0605 | K30TLG0605 |
| TLG / KSK 90° 0808 | K10FTLG0808 | K30TLG0808 |
| TLG / KSK 90° 1010 | K10FTLG1010 | K30TLG1010 |
| TLG / KSK 90° 1212 | K10FTLG1212 | K30TLG1212 |
| TLG / KSK 90° 1613 | K10FTLG1613 | K30TLG1613 |
| TLG / KSK 90° 2020 | K10FTLG2020 | K30TLG2020 |

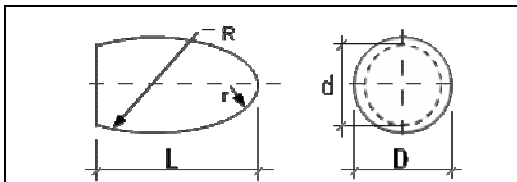

| | | |
|-----------------------|-------------|------------|
| TLH / TRE 0610 | K10FTLH0610 | K30TLH0610 |
| TLH / TRE 0813 | K10FTLH0813 | K30TLH0813 |
| TLH / TRE 1016 | K10FTLH1016 | K30TLH1016 |
| TLH / TRE 1220 | K10FTLH1220 | K30TLH1220 |
| TLH / TRE 1625 | K10FTLH1625 | K30TLH1625 |
| TLH / TRE 2025 | K10FTLH2025 | K30TLH2025 |

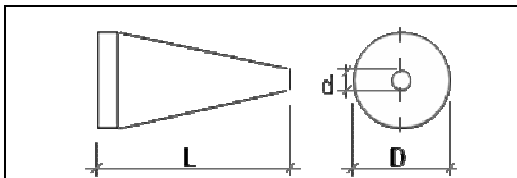

| | | |
|-----------------------|-------------|------------|
| TLI / SKM 0613 | K10FTLI0613 | K30TLI0613 |
| TLI / SKM 0818 | K10FTLI0818 | K30TLI0818 |
| TLI / SKM 1020 | K10FTLI1020 | K30TLI1020 |
| TLI / SKM 1225 | K10FTLI1225 | K30TLI1225 |
| TLI / SKM 1625 | K10FTLI1625 | K30TLI1625 |
| TLI / SKM 2025 | K10FTLI2025 | K30TLI2025 |

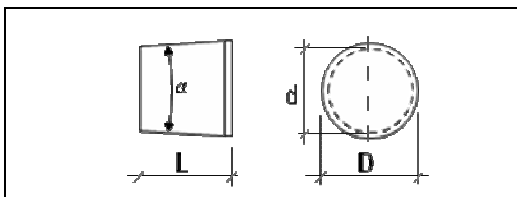

| | | |
|-----------------------|-------------|------------|
| TLL / WKN 0606 | K10FTLL0606 | K30TLL0606 |
| TLL / WKN 0808 | K10FTLL0808 | K30TLL0808 |
| TLL / WKN 1010 | K10FTLL1010 | K30TLL1010 |
| TLL / WKN 1212 | K10FTLL1212 | K30TLL1212 |
| TLL / WKN 1616 | K10FTLL1616 | K30TLL1616 |
| TLL / WKN 2020 | K10FTLL2020 | K30TLL2020 |

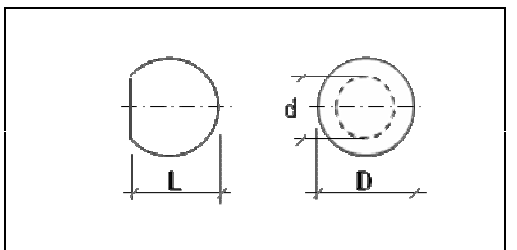

| | | |
|-------------------------|---------------|--------------|
| TLM / KUD 0403.5 | K10FTLM0403.5 | K30TLM0403.5 |
| TLM / KUD 0504 | K10FTLM0504 | K30TLM0504 |
| TLM / KUD 0605 | K10FTLM0605 | K30TLM0605 |
| TLM / KUD 0807 | K10FTLM0807 | K30TLM0807 |
| TLM / KUD 1009 | K10FTLM1009 | K30TLM1009 |
| TLM / KUD 1210.5 | K10FTLM1210.5 | K30TLM1210.5 |
| TLM / KUD 1614 | K10FTLM1614 | K30TLM1614 |
| TLM / KUD 2018 | K10FTLM2018 | K30TLM2018 |

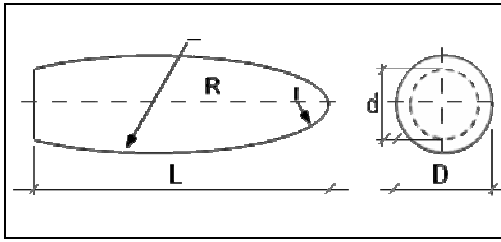

| 无 DIN标准 | | | | | | 项代码 | 项代码 |
|---------------|----|----|----|-----|------|-------------|------------|
| | D | L | R | r | d | | |
| TLS 08 | 8 | 20 | 26 | 1.3 | 6.0 | K10FTLS0820 | K30TLS0820 |
| TLS 10 | 10 | 25 | 33 | 1.5 | 6.0 | K10FTLS1025 | K30TLS1025 |
| TLS 12 | 12 | 30 | 40 | 2.0 | 8.0 | K10FTLS1230 | K30TLS1230 |
| TLS 16 | 16 | 35 | 47 | 4.0 | 12.5 | K10FTLS1635 | K30TLS1635 |